



December 6, 2023

Brian Howell, PLA
HRC Engineers
6554 East Church Street
Douglasville, Georgia

Subject: Report of Findings
Hiram Veterans Hwy
33.874447, -84.758018
Hiram, Paulding County, Georgia

Mr. Howell:

Per your request, on January 2nd, 2023, TerraBuild USA completed a stream and wetland delineation for the above-referenced location. The purpose of our site visit was to investigate the presence of any streams and/or wetlands located within the property.

Delineation – Discussion

Jurisdictional waters of the U.S., including streams, wetlands, lakes, and ponds, are defined by 33 CFR Part 328.3 and protected by Section 404 of the Clean Water Act (33 USC 1344), which is administered and enforced by the U.S. Army Corps of Engineers (USACE), Savannah District. Jurisdictional waters were delineated June 4th 2020. The delineation was conducted using the Routine Onsite Determination Method as described in the U.S. Army Corps of Engineers (USACE) January 1987 – Final Report Wetlands Delineation Manual (Technical Report Y-87-1) and the regional supplement for the Eastern Mountains and Piedmont Region. The referenced manuals use a multi-parameter wetland/stream identification process, including positive evidence of three criteria: 1) hydrophytic vegetation; 2) hydric soils; and 3) wetland hydrology. Any areas exhibiting all three criteria for wetland determination, as well as seasonal stream and ponds, are considered jurisdictional waters regulated by the USACE.

Determinations were also made as to whether these areas qualified as State Waters requiring buffers. State Waters of Georgia, including streams and wetlands, are defined by Chapter 391-3-7-.01(x) of the Georgia Department of Natural Resources, Environmental Protection Division (EPD) Rules for Erosion and Sedimentation Control and were identified using the Georgia EPD's Field Guide for Determining the Presence of State Waters that Require a Buffer.

P.O. Box 601 Lilburn, GA 30048 PH: (770) 900-7619



Results

Site Conditions & Jurisdictional Waters

Site conditions were assessed through a desktop review of available environmental information and physical reconnaissance of the project site. The review of available environmental information and site visit revealed evidence of several stream features and forested wetlands.

Seepage/Linear Wetlands #1- Originates just below the toe of slope of the backside of the dam.

Intermittent Stream #1- Originates just below the Linear Wetland and flows in a westerly direction off property. This Stream requires a 25-foot Undisturbed State Buffer, 50-foot Undisturbed Local Buffer, and a 75-foot Impervious Setback.

Manmade Stormwater Pond #1- The existing pond on the property is a man-made structure. There isn't an intermittent or perennial streams that discharge into this pond. The only water that enters the pond is storm water run-off that sheet flows from the adjacent properties to the east and surrounding roadways. With only run-off entering the pond this classifies it as a stormwater facility. A storm water facility does not require any buffers or setbacks.

Any impacts to the linear wetlands or intermittent stream will require permitting with the Army Corps of Engineers.

Should you require any other information please don't hesitate to contact me by phone or email (jhamilton@terrabuildusa.com).

Sincerely,
TerraBuild USA, Inc.

Jack T. Hamilton
Environmental Consultant
(770) 900-7619

P.O. Box 601 Lilburn, GA 30048 PH: (770) 900-7619

EROSION AND SEDIMENT CONTROL SCHEDULE

1. PLACE CONSTRUCTION EXIT.
2. PLACE EROSION AND SEDIMENT CONTROL DEVICES AND "SILT FENCE".
3. PLACE TREE PROTECTION FENCE IN CRITICAL ROOT ZONE & CALL FOR INSPECTION.
4. TEMPORARY SEDIMENT POND FEATURES AND SILT CONTROL FENCE ARE TO BE CONSTRUCTED AND FULLY FUNCTIONAL PRIOR TO ANY GRADING.
5. GRADE TEMPORARY CONSTRUCTION SWALES TO ON-SITE SEDIMENT CONTROL PONDS, DETENTION PONDS, AND DRZ INLETS.
6. CLEAR, STRIP & PROVIDE TEMPORARY SWALES TO SILT COLLECTION POINTS.
7. GRADE ROADS AND BUILDINGS-- SLOPE ROADS TO SD2 INLETS.
8. CONSTRUCT UNDERGROUND UTILITIES-- CONSTRUCT SD2 INLETS AS SOON AS POSSIBLE.
9. ROADWAY CURBING AND BASE PAVING WILL BE INSTALLED AFTER UTILITY INSTALLATION HAS BEEN COMPLETED.
10. RETAIN ALL NATURAL VEGETATION. SAVE AREAS NOTED ON STAKING PLANS.
11. LANDSCAPING WILL BE PERFORMED AS SOON AS PRACTICAL AFTER BUILDING CONSTRUCTION IS COMPLETE. APPROPRIATE PLANT MATERIAL SHALL BE INSTALLED AREA BY AREA AS SITE WORK PERMITS.
12. SEDIMENT BASINS AND CONTROL DEVICES WILL REMAIN IN PLACE AND IN WORKING ORDER UNTIL CONSTRUCTION IS COMPLETE AND THEY BECOME UNNECESSARY.
13. CLEAN PONDS AS REQUIRED TO MAINTAIN DESIGN VOLUME OR BEFORE ONE-HALF FULL.

PAULDING COUNTY GENERAL NOTES

- ADDITIONAL EROSION CONTROL DEVICES TO BE USED AS REQUIRED BY PAULDING COUNTY.
- DISTURBED AREAS LEFT IDLE FOR TWO TO FOUR WEEKS, AND NOT TO FINAL GRADE, WILL BE ESTABLISHED TO TEMPORARY VEGETATION (D_{s2}). DISTURBED AREAS LEFT IDLE FOR FOUR WEEKS OR MORE WILL BE ESTABLISHED TO PERMANENT VEGETATION (D_{s3} OR D_{s4}). ALL AREAS TO FINAL GRADE WILL BE ESTABLISHED TO PERMANENT VEGETATION WITHIN TWO WEEKS.
- WHEN HAND PLANTING, MULCH (HAY OR STRAW) SHOULD BE UNIFORMLY SPREAD OVER SEEDING AREA WITHIN 24 HOURS OF SEEDING.
- DURING UNSUITABLE GROWING SEASONS, MULCH WILL BE USED AS TEMPORARY COVER (D_{s1}). ON SLOPES THAT ARE 4:1 OR STEEPER, MULCH WILL BE ANCHORED.
- PAULDING COUNTY LAND DISTURBANCE PERMIT MUST BE DISPLAYED ON SITE AT ALL TIMES DURING AND IN PLAIN VIEW FROM A COUNTY ROAD OR STREET.
- EROSION AND SEDIMENT CONTROL DEVICES MUST BE INSTALLED AND INSPECTED PRIOR TO ANY GRADING ON SITE. CALL (770) 443-7601 FOR AN INSPECTION.
- SEDIMENT/ EROSION CONTROL DEVICES MUST BE CHECKED BY THE DEVELOPER AFTER EACH STORM EVENT. EACH DEVICE IS TO BE MAINTAINED OR REPLACED IF SEDIMENT ACCUMULATION HAS REACHED ONE HALF THE CAPACITY OF THE DEVICE.
- OWNER/ DEVELOPER TO EXECUTE MAINTENANCE AGREEMENT FOR COMMERCIAL AND OR PRIVATE PONDS AT OR BEFORE C.O.
- WATER QUALITY (WQ) FEATURES TO BE INSTALLED AT 80% BUILD-OUT OR END OF WARRANTY.
- DEVELOPER SHALL ATTEND A PRE-CONSTRUCTION CONFERENCE AT THE PROJECT SITE WITH REPRESENTATIVES OF THE PAULDING COUNTY DEPARTMENTS OF COMMUNITY DEVELOPMENT, TRANSPORTATION AND WATER, SEWER & ENVIRONMENTAL SERVICES.
- INCLUDE THE STATEMENT IN BOLD LETTERS THAT **"WASHOUT OF THE CONCRETE TRUCK MIXER DRUM AT THE CONSTRUCTION SITE IS PROHIBITED PER NPDES GENERAL PERMITS.**
- AN AS BUILT POND CERTIFICATION LETTER FOR ALL PONDS MUST BE COMPLETED PRIOR TO C.O.
- Construction equipment shall not be parked in right-of-way, and must be stored within site
- ALL PROPOSED RCP SHALL BE CLASS III UNLESS NOTED OTHERWISE

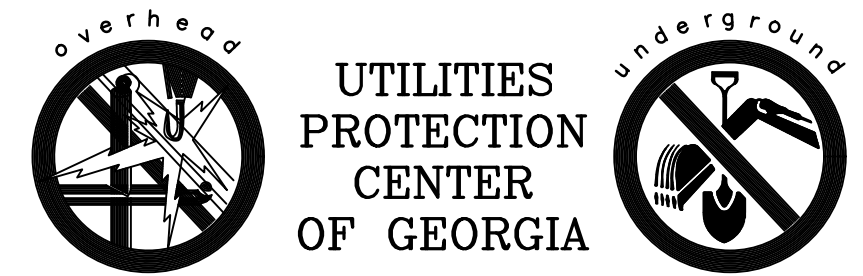

BEFORE ANY EXCAVATION WORK BEGINS OR ANY WORK BEGINS WITHIN TEN(10') FT. OF OVERHEAD POWER LINES OF 750 VOLTS OR MORE, NOTIFICATION MUST BE MADE TO THE UTILITIES PROTECTION CENTER (UPC) AT 1-800-282-7411 (770-623-4344 IN METRO ATLANTA).

IT IS THE CONTRACTORS RESPONSIBILITY TO LOCATE ALL UNDERGROUND UTILITIES BEFORE BEGINNING CONSTRUCTION AND ADVISE ENGINEERING OF ANY CONFLICTS. ALL LOCATION OF UTILITIES SHOWN ON THESE DRAWINGS IS APPROXIMATE AND MAY NOT BE A COMPLETE LOCATION OF ALL UTILITIES. CERTIFICATION TO THE LOCATION OF ALL UTILITIES IS WITHHELD.

ES&PC NOTES

EROSION & SEDIMENT CONTROL NOTES

1. THE ESCAPE OF SEDIMENT FROM THE SITE SHALL BE PREVENTED BY THE INSTALLATION OF EROSION AND SEDIMENT CONTROL MEASURES AND PRACTICES PRIOR TO LAND DISTURBING ACTIVITIES.
2. EROSION CONTROL MEASURES WILL BE MAINTAINED AT ALL TIMES. IF FULL IMPLEMENTATION OF THE APPROVED PLAN DOES NOT PROVIDE FOR EFFECTIVE EROSION CONTROL, ADDITIONAL EROSION AND SEDIMENT CONTROL MEASURES SHALL BE IMPLEMENTED TO CONTROL OR TREAT THE SEDIMENT SOURCE.
3. ALL DISTURBED AREAS MUST BE STABILIZED WITH MULCH OR TEMPORARY SEEDING AS SOON AS POSSIBLE BUT NOT LONGER THAN 14 DAYS AFTER DISTURBANCE.
4. NON EXEMPT ACTIVITIES SHALL NOT BE CONDUCTED WITHIN THE 25 OR 50-FOOT UNDISTURBED STREAM BUFFERS AS MEASURED FROM THE POINT OF WRESTED VEGETATION OR WITHIN 25 FEET OF THE COASTAL MARSHLAND BUFFER AS MEASURED FROM THE JURISDICTIONAL DETERMINATION LINE WITHOUT FIRST ACQUIRING THE NECESSARY VARIANCES AND PERMITS.
5. ALL CONTRACTORS FOR EROSION SEDIMENTATION AND POLLUTION CONTROL SHALL BE APPROVED BY THE AUTHORITY.
6. THE CONTRACTOR MUST NOTIFY THE UTILITIES PROTECTION CENTER AT 1-800-282-7411 AT LEAST 72 HOURS PRIOR TO COMMENCEMENT OF LAND-DISTURBING ACTIVITIES.
7. STRIPPING OF VEGETATION, REGRADING, AND OTHER DEVELOPMENT ACTIVITIES SHALL BE CONDUCTED IN SUCH A MANNER SO AS TO MINIMIZE EROSION.
8. CUT AND FILL OPERATIONS SHALL BE KEPT TO A MINIMUM.
9. DEVELOPMENT PLANS MUST CONFORM TO TOPOGRAPHY AND SOIL TYPE, SO AS TO CREATE THE LOWEST PRACTICABLE EROSION POTENTIAL.
10. WHENEVER FEASIBLE, NATURAL VEGETATION SHALL BE RETAINED, PROTECTED, AND SUPPLEMENTED.
11. DISTURBED AREAS AND THEIR DURATION OF EXPOSURE TO EROSION ELEMENTS SHALL BE KEPT TO A PRACTICABLE MINIMUM.
12. DISTURBED SOIL SHALL BE STABILIZED AS QUICKLY AS PRACTICABLE.
13. TEMPORARY VEGETATION OR MULCHING SHALL BE EMPLOYED TO PROTECT EXPOSED CRITICAL AREAS DURING DEVELOPMENT.
14. PERMANENT VEGETATION AND STRUCTURAL EROSION CONTROL MEASURES SHALL BE INSTALLED AS SOON AS PRACTICABLE.
15. TO THE EXTENT NECESSARY, SEDIMENT IN RUN-OFF WATER SHALL BE TRAPPED BY THE USE OF DESIGNS BASINS, SEDIMENT BASINS, SILT TRAPS, OR SIMILAR MEASURES UNTIL THE DISTURBED AREA IS STABILIZED.
16. ADEQUATE PROVISIONS SHALL BE PROVIDED TO MINIMIZE DAMAGE FROM SURFACE WATER TO THE CUT FACE OF EXCAVATIONS OR THE SLOPING SURFACES OF FILLS.
17. CUTS AND FILLS SHALL NOT ENDANGER ADJOINING PROPERTY.
18. FILLS SHALL NOT ENCROACH UPON NATURAL WATERCOURSES OR CONSTRUCTED CHANNELS IN A MANNER THAT WOULD ADVERSELY AFFECT OTHER PROPERTY OWNERS.
19. GRADING EQUIPMENT MUST CROSS FLOWING STREAMS BY THE MEANS OF BRIDGES OR CULVERTS, EXCEPT WHEN SUCH METHODS ARE NOT FEASIBLE. PROVIDED IN ANY CASE THAT SUCH CROSSINGS SHALL BE KEPT TO A MINIMUM AND THAT A PROPERLY TEMPORARY STREAM CROSSING IS CONSTRUCTED IN ACCORDANCE WITH STATE AND LOCAL REGULATIONS.
20. PROVISIONS SHALL BE PROVIDED FOR TREATMENT OR CONTROL OF ANY SOURCE OF SEDIMENTS AND ADEQUATE SEDIMENTATION CONTROL FACILITIES TO RETAIN SEDIMENTS ON SITE OR PRECLUDE SEDIMENTATION OF ADJACENT WATERS BEYOND THE LEVELS SPECIFIED IN THIS PERMIT.
21. NO CONSTRUCTION ACTIVITIES SHALL BE CONDUCTED WITHIN A 50-FOOT BUFFER ALONG THE BANKS OF ALL STATE WATERS (AS MEASURED HORIZONTALLY FROM THE POINT WHERE VEGETATION HAS BEEN WRESTED BY NORMAL STREAM FLOW OR WAVE ACTION) UNLESS A FORMAL WAIVER HAS BEEN GRANTED BY THE AUTHORITY.
22. WHERE THE AUTHORITY GRANTS A WAIVER, NO CONSTRUCTION ACTIVITIES SHALL BE CONDUCTED WITHIN A 50-FOOT BUFFER STATE BUFFER WITHOUT FULL COMPLIANCE OF STATE REGULATIONS AND OBTAINING A VARIANCE IF APPLICABLE.
23. EXCEPT AS PROVIDED ABOVE, FOR REQUIRED BUFFERS NO CONSTRUCTION ACTIVITIES SHALL BE CONDUCTED WITHIN A BUFFER AND A BUFFER SHALL REMAIN IN ITS NATURAL, UNDISTURBED, STATE OF VEGETATION.
24. NO LAND DISTURBING ACTIVITIES SHALL BE CONDUCTED IN A BUFFER. ONCE THE FINAL STABILIZATION OF THE SITE IS ACHIEVED AND A VALID NOTICE OF TERMINATION IS SUBMITTED, A BUFFER MAY BE THINNED OR TRIMMED OF VEGETATION AS LONG AS A PROTECTIVE VEGETATIVE COVER REMAINS TO PROTECT WATER QUALITY AND AQUATIC HABITAT AND A NATURAL CANOPY IS LEFT IN SUFFICIENT QUANTITY TO KEEP SHADE ON THE STREAMBED.

Ss EROSION CONTROL BLANKET IS REQUIRED ON ALL SLOPES 2.5:1 OR STEEPER & GREATER THAN 10 FEET.

PERSON RESPONSIBLE FOR THE INSTALLATION AND MAINTENANCE OF EROSION CONTROL DEVICES AND MEASURES IS:

CITY OF HIRAM
217 MAIN STREET
HIRAM, GEORGIA 30141
24 hr. CONTACT: JODY PALMER
PH: (678) 776-8929



HUGHES-REAY COMPANY, INC.
6554 EAST CHURCH STREET
DOUGLASSVILLE, GEORGIA 30134
P 770.942.0196
F 770.942.0152
www.HughesRay.com

REVISION	PC COMMENTS	PC COMMENTS	PLANT MODIFICATION	LANDSCAPE MODIFICATION	ADDENDUM #1
No.	DATE:	2/16/24	2/28/24	3/4/24	5/10/24
1					
2					
3					
4					
5					

GENERAL NOTES
OF
HIRAM VETERAN'S MEMORIAL
L.L. 753, 2nd DISTRICT, 3rd SECTION
CITY OF HIRAM, PAULDING COUNTY, GEORGIA

OWNER:
CITY OF HIRAM

DEVELOPER:
JODY PALMER
24 HR. CONTACT:
CONTACT NAME
678.776.8929

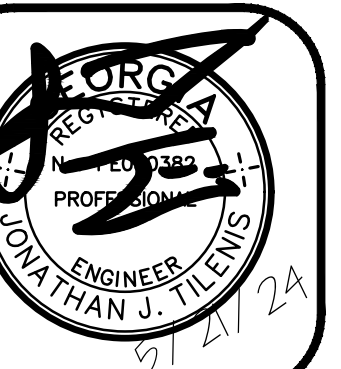

DATE: 02/28/24
DRAWN BY: DNW
CHECKED BY: JTT

JOB#: H23221

GN1

GEORGIA UNIFORM CODING SYSTEM FOR SOIL EROSION AND SEDIMENT CONTROL PRACTICES

GEORGIA SOIL AND WATER CONSERVATION COMMISSION

STRUCTURAL PRACTICES

CODE	PRACTICE	DETAIL	MAP SYMBOL	DESCRIPTION
Cd	DEEPCRAM			A small temporary barrier or dam constructed across a swale, drainage ditch or area of concentrated flow.
Ch	CHANNEL STABILIZATION			Improving, constructing or stabilizing an open channel, existing stream, or ditch.
Co	CONSTRUCTION EXIT			A crushed stone pad located at the construction site exit to provide a place for removing mud from tires thereby protecting public streets.
Cr	CONSTRUCTION ROAD STABILIZATION			A driveway constructed as part of a construction plan including access roads, subdivision roads, parking areas and other on-site vehicle transportation routes.
Dc	STREAM DIVERSION CHANNEL			A temporary channel constructed to convey flow around a construction site while a permanent structure is being constructed.
Di	DIVERSION			An earth channel or dike located above, below or across a slope to divert runoff. This may be a temporary or permanent structure.
Dn1	TEMPORARY DOWNDRAIN STRUCTURE			A flexible conduit of heavy-duty fabric or other material designed to safely conduct surface runoff down a slope. This is temporary and inexpensive.
Dn2	PERMANENT DOWNDRAIN STRUCTURE			A paved chute, pipe, sectional conduit or similar material designed to safely conduct surface runoff down a slope.
Fr	FILTER RING			A temporary stone barrier constructed at storm drain inlets and pond outlets.
Ga	GABION			Rock filter baskets which are hand-placed into position forming soil stabilizing structures.
Gr	GRADE STABILIZATION STRUCTURE			Permanent structures installed to protect channels or waterways where otherwise the slope would be sufficient for the running water to form gullies.
Lv	LEVEL SPREADER			A structure to convert concentrated flow of water into less erosive sheet flow. This should be constructed only on undisturbed soil.
Rd	ROCK FILTER DAM			A permanent or temporary stone filter dam installed across small streams or drainageways.
Re	RETAINING WALL			A wall installed to stabilize cut and fill slopes where maximum permissible slopes are not obtainable. Each situation will require special design.
Rt	RETRO FITTING			A device or structure placed in front of a temporary stormwater detention pond outlet structure to serve as a temporary sediment filter.
Sd1	SEDIMENT BARRIER			A barrier to prevent sediment from leaving the construction site. It may be sandbags, bales of straw or hay, brush, logs and poles, gravel, or a silt fence.
Sd2	INLET SEDIMENT TRAP			An impounding area created by excavating around a storm drain drop inlet. The excavated area will be filled and stabilized on completion of construction activities.
Sd3	TEMPORARY SEDIMENT BASIN			A basin created by excavation or a dam across a waterway. The surface water runoff is temporarily stored allowing the bulk of the sediment to drop out.
Sd4	TEMPORARY SEDIMENT TRAP			A small temporary pond that drains a disturbed area so that sediment can settle out. The principle feature distinguishing a temporary sediment trap from a temporary sediment basin is the lack of a pipe or riser.
Sk	FLOATING SURFACE SKIMMER			A buoyant device that releases/drains water from the surface of sediment ponds, traps, or basins at a controlled rate of flow.
Spb	SEEP BERM			Linear control device constructed as a diversion perpendicular to the direction of runoff to enhance dissipation and infiltration, while creating multiple sedimentation chambers with the employment of intermediate dikes.

STRUCTURAL PRACTICES

CODE	PRACTICE	DETAIL	MAP SYMBOL	DESCRIPTION
Sr	TEMPORARY STREAM CROSSING			A temporary bridge or culvert-type structure protecting a stream or watercourse from damage by crossing construction equipment.
St	STORMDRAIN OUTLET PROTECTION			A paved or short section of riprap channel at the outlet of a storm drain system preventing erosion from the concentrated runoff.
Su	SURFACE ROUGHENING			A rough soil surface with horizontal depressions on a contour or slopes left in a roughened condition after grading.
Tc	TURBIDITY CURTAIN			A floating or staked barrier installed within the water (it may also be referred to as a floating boom, silt barrier, or silt curtain).
Tp	TOPSOILING			The practice of stripping off the more fertile soil, storing it, then spreading it over the disturbed area after completion of construction activities.
Tr	TREE PROTECTION			To protect desirable trees from injury during construction activity.
Wt	VEGETATED WATERWAY OR STORMWATER CHANNEL			Paved or vegetative water outlets for diversions, terraces, berms, dikes or similar structures.

VEGETATIVE PRACTICES

CODE	PRACTICE	DETAIL	MAP SYMBOL	DESCRIPTION
Bf	BUFFER ZONE			Strip of undisturbed original vegetation, enhanced or restored existing vegetation or the reestablishment of vegetation surrounding an area of disturbance or bordering streams.
Cs	COASTAL DUNE STABILIZATION (WITH MULCHING ONLY)			Planting vegetation on dunes that are denuded artificially constructed, or re-nourished.
Ds1	DISTURBED AREA STABILIZATION (WITH MULCHING ONLY)			Establishing temporary protection for disturbed areas where seedlings may not have a suitable growing season to produce an erosion retarding cover.
Ds2	DISTURBED AREA STABILIZATION (WITH TEMP SEEDING)			Establishing a temporary vegetative cover with fast growing seedlings on disturbed areas.
Ds3	DISTURBED AREA STABILIZATION (WITH PERM SEEDING)			Establishing a permanent vegetative cover such as trees, shrubs, vines, grasses, or legumes on disturbed areas.
Ds4	DISTURBED AREA STABILIZATION (SOODING)			A permanent vegetative cover using sods on highly erodible or critically eroded lands.
Du	DUST CONTROL ON DISTURBED AREAS			Controlling surface and air movement of dust on construction site, roadways and similar sites.
Fl-Cc	FLOCCULANTS AND COAGULANTS			Substance formulated to assist in the solids/liquid separation of suspended particles in solution.
Sb	STREAMBANK STABILIZATION (USING TEMP VEGETATION)			The use of readily available native plant materials to maintain and enhance streambanks, or to prevent, or restore and repair small streambank erosion problems.
Ss	SLOPE STABILIZATION			A protective covering used to prevent erosion and establish temporary or permanent vegetation on steep slopes, shore lines, or channels.
Tac	TACKERS AND BINDERS			Substance used to anchor straw or hay mulch by causing the organic material to bind together.

GeSWCC (Amended - 2013)

VEGETATIVE PLAN

SEEDING RATES FOR TEMPORARY SEEDINGS		Ds2 Du	
Species	Rate Per 1,000 sq. ft. Per Acre	Rate	Planting Dates
Winter Rye (Secale cereale)	0.8 lbs.	28 lbs.	9/15-4/15 10/1-3/15 10/15-2/15
Mix when appropriate with: Unhulled 0.2 lbs. Common Bermudagrass (Cynodon dactylon)	6-8 lbs.	10/1-4/15 9/15-3/15 10/15-2/15	

Lespedeza 0.2 lbs. (Lespedeza striata)	8-10 lbs.	9/15-4/15 10/1-3/15 10/15-2/15
Mix when appropriate with: Common Bermudagrass (Cynodon dactylon)	0.2 lbs.	4/15-10/1 3/15-9/15 2/15-10/15

Unusual site conditions may require heavier seeding rates. Seeding dates may need to be altered to fit temperature variations and local conditions. The above application rates are for erosion control purposes only. See Landscape Plan for FINAL vegetation. Add 1 TON OF LIME PER DISTURBED ACRE unless soil test indicate otherwise. Add 1000 lbs. OF 6-12-12 FERTILIZER PER GRASSSED ACRE unless soil test indicate otherwise.

SEEDING RATES FOR PERMANENT SEEDINGS		Ds3 Du	
Species	Rate Per 1,000 sq. ft. Per Acre	Rate	Planting Dates
Unhulled 0.2 lbs. Common Bermudagrass (Cynodon dactylon)	6-8 lbs.	9/15-4/15 9/15-3/15 10/15-2/15	
Mixed with: Winter Rye 0.6 lbs. (Secale cereale)	28 lbs.		
0.23 lbs. Common Bermudagrass (Cynodon dactylon)	8-10 lbs.	4/15-10/1 3/15-9/15 2/15-10/15	

Unusual site conditions may require heavier seeding rates. Seeding dates may need to be altered to fit temperature variations and local conditions. The above application rates are for erosion control purposes only. See Landscape Plan for FINAL vegetation. Add 2 TON OF LIME PER DISTURBED ACRE unless soil test indicate otherwise. Add 1500 lbs. OF 6-12-12 FERTILIZER PER GRASSSED ACRE unless soil test indicate otherwise.

MULCHING RATES: Ds1 Du ALTERNATIVE = Tb

Mulching with permanent vegetation:
Mulch is required for all permanent vegetation applications. Mulch applied to seeded areas shall achieve 75% soil cover. Dry straw mulch shall be applied at a rate of 2 tons per acre. Dry hay mulch shall be applied at a rate of 2.5 tons per acre.

Mulching Only:
Straw/Hay Shall be applied at 2-4 inches depth providing complete soil coverage.

ALTERNATIVE Tb IF ABOVE TREATMENT IS INEFFECTIVE USE APPROVED TACKIFIERS AND BINDERS

Product or Trade Name	Recommended Application Rate
A500 HYDRO-STK	40 lb./ac.
Agro Tack MP	PMR
CONVED CON-TAC	40 lb./ac.
EcoTack-OP/EcoTack-SATII	PMR
Emulsified Asphalt	100 gal. of SS-1h or CSS-1h and 100 gal. of water per ton of mulch
Hercules Soilloc-E	PMR
HYDRO-BOND	35 lb./ac.
RMB-plus	80-120 lb./ac.
TACCAP GT	PMR
TERRA-MULCH	PMR
TACKING AGENT III	PMR

ANTICIPATED SEEDING SCHEDULE PIEDMONT REGION												
TEMPORARY SEEDING Ds2	J	F	M	A	M	J	J	A	S	O	N	D
WINTER RYE (Secale cereale)												
WINTER RYE mixed w/ UNHULLED COMMON BERMU (Cynodon dactylon)												
ANNUAL LESEDEZA (Lespedeza striata)												
ANNUAL LESEDEZA mixed w/ HULLED COMMON BERMU (Cynodon dactylon)												
PERMANENT SEEDING Ds3	J	F	M	A	M	J	J	A	S	O	N	D
UNHULLED COMMON BERMU (Cynodon dactylon) mixed w/ WINTER RYE (Secale cereale)												
HULLED COMMON BERMU (Cynodon dactylon)												
COMMON BERMU mixed w/ ANNUAL LESEDEZA (Lespedeza striata)												

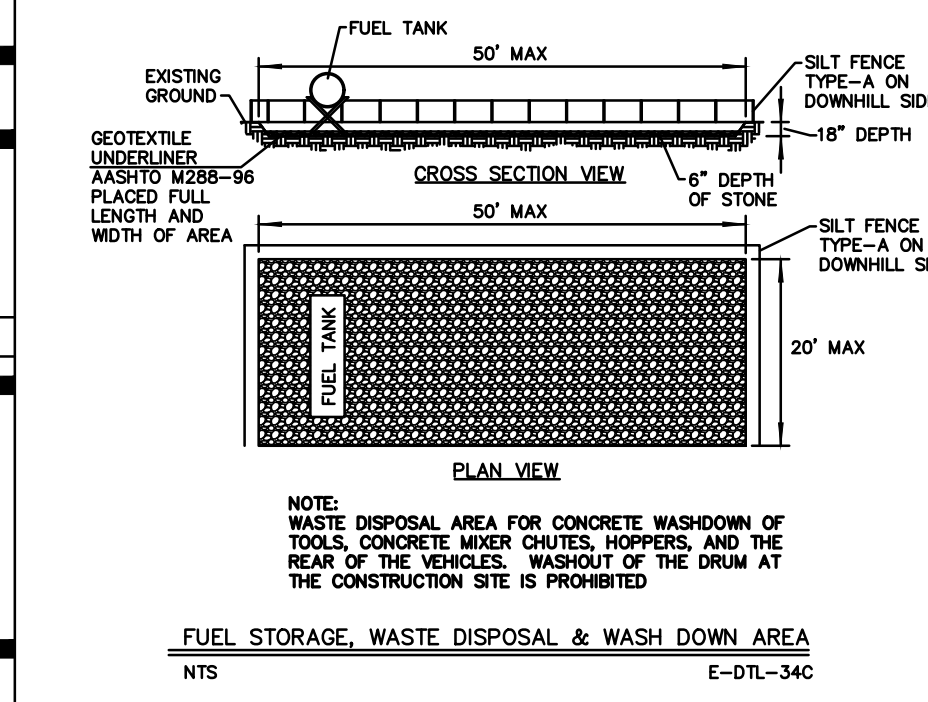

OPERATING AND INSPECTING WASHOUT FACILITIES CONCRETE WASHOUT FACILITIES SHOULD BE INSPECTED DAILY AND AFTER HEAVY RAINS TO CHECK FOR LEAKS, IDENTIFY ANY PLASTIC LININGS AND SIDEWALLS HAVE BEEN DAMAGED BY CONSTRUCTION ACTIVITIES, AND DETERMINE WHETHER THEY HAVE BEEN FILLED TO OVER 75 PERCENT CAPACITY. WHEN THE WASHOUT AREA IS FILLED TO OVER 75 PERCENT OF ITS CAPACITY, THE WASHOUTER SHOULD BE VACUUMED OFF OR ALLOWED TO EVAPORATE TO AVOID OVERFLOWS. WHEN THE REMAINING CEMENTITIOUS SOLIDS HAVE HARDENED, THEY SHOULD BE REMOVED AND RECYCLED. BEFORE HEAVY RAINS, THE WASHOUT AREA LIQUID LEVEL SHOULD BE LOWERED OR THE AREA SHALL BE COVERED TO AVOID AN OVERFLOW DURING THE RAIN STORM.

CONCRETE WASHOUT FACILITIES, SUCH AS WASHOUT PITS AND VINYL OR METAL WASHOUT CONTAINERS, SHOULD BE PLACED IN LOCATIONS THAT PROVIDE CONVENIENT ACCESS TO CONCRETE TRUCKS, PREFERABLY NEAR THE AREA WHERE CONCRETE IS BEING POURED. HOWEVER, THEY SHOULD NOT BE PLACED WITHIN 50 FEET OF STORM DRAINS, OPEN DITCHES, OR WATERBODIES. APPROPRIATE GRAVEL OR ROCK SHOULD COVER APPROACHES TO CONCRETE WASHOUT FACILITIES WHEN THEY ARE LOCATED ON UNDEVELOPED PROPERTY. IF THE WASHOUT FACILITY IS NOT WITHIN VIEW FROM THE FOUR LOCATIONS, SIGNAGE WILL BE NEEDED TO DIRECT THE TRUCK DRIVERS.

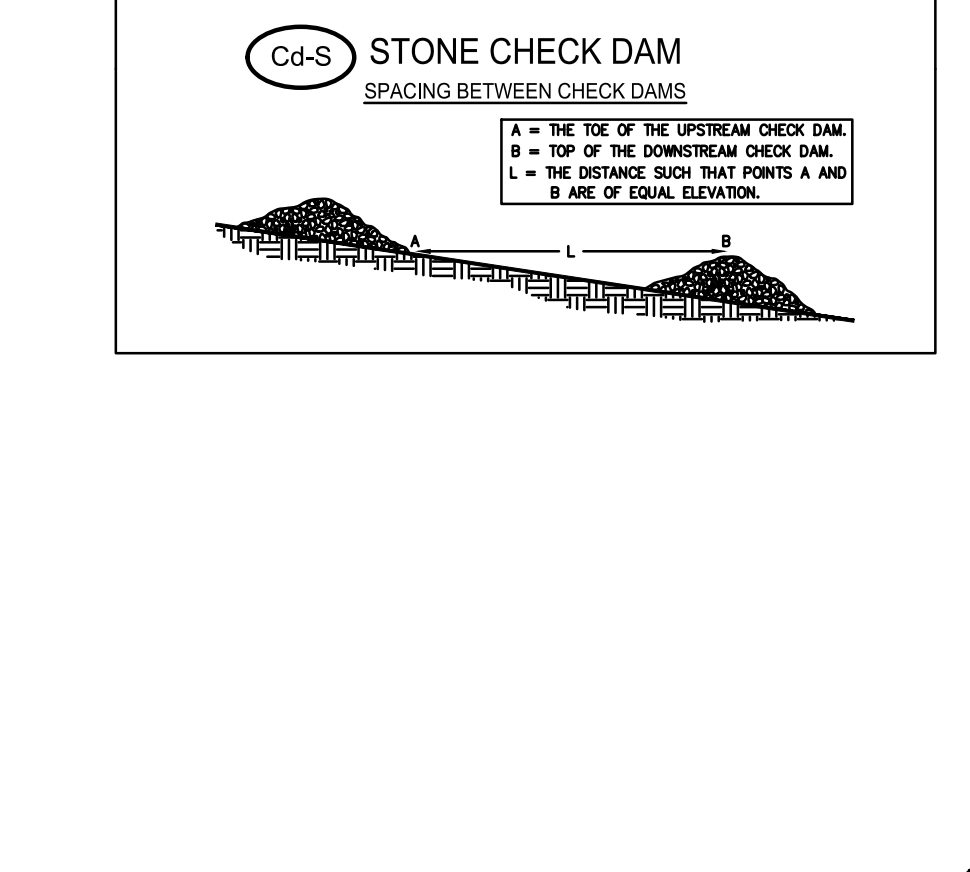
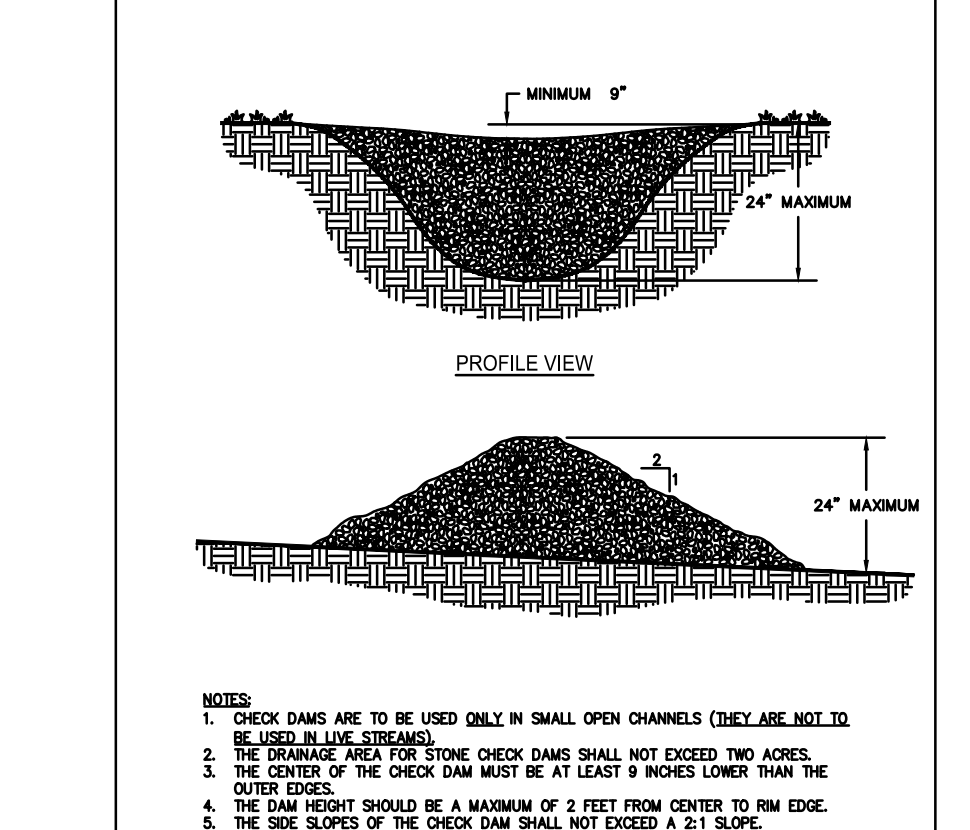
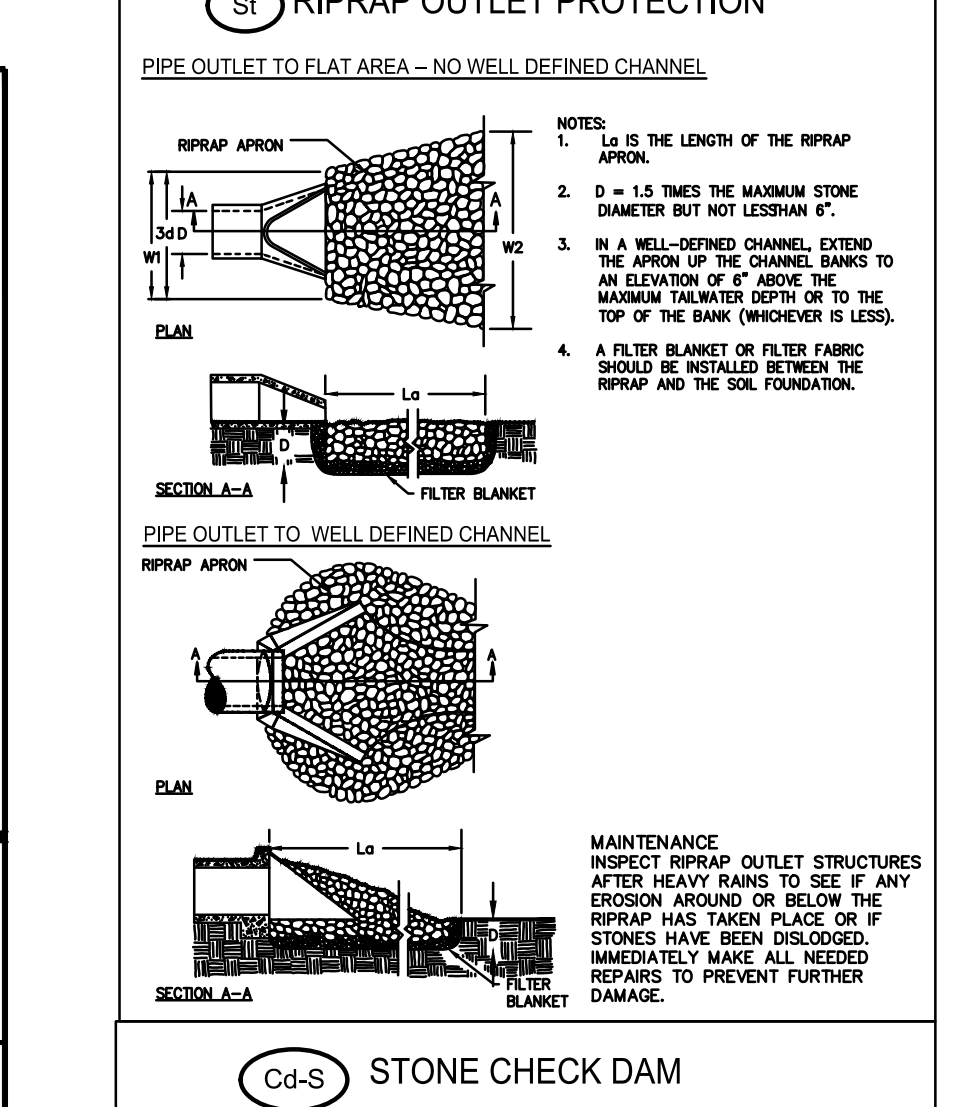
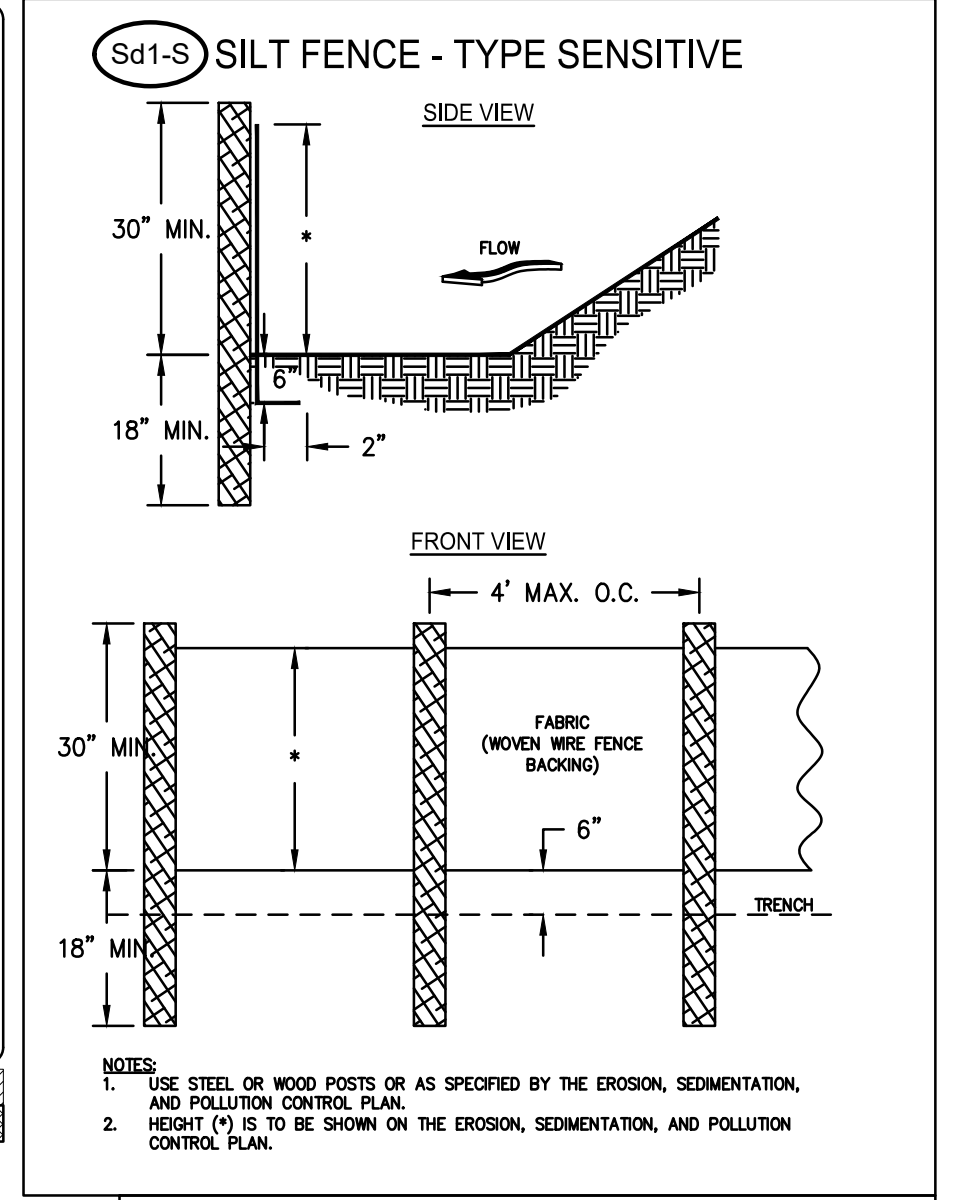
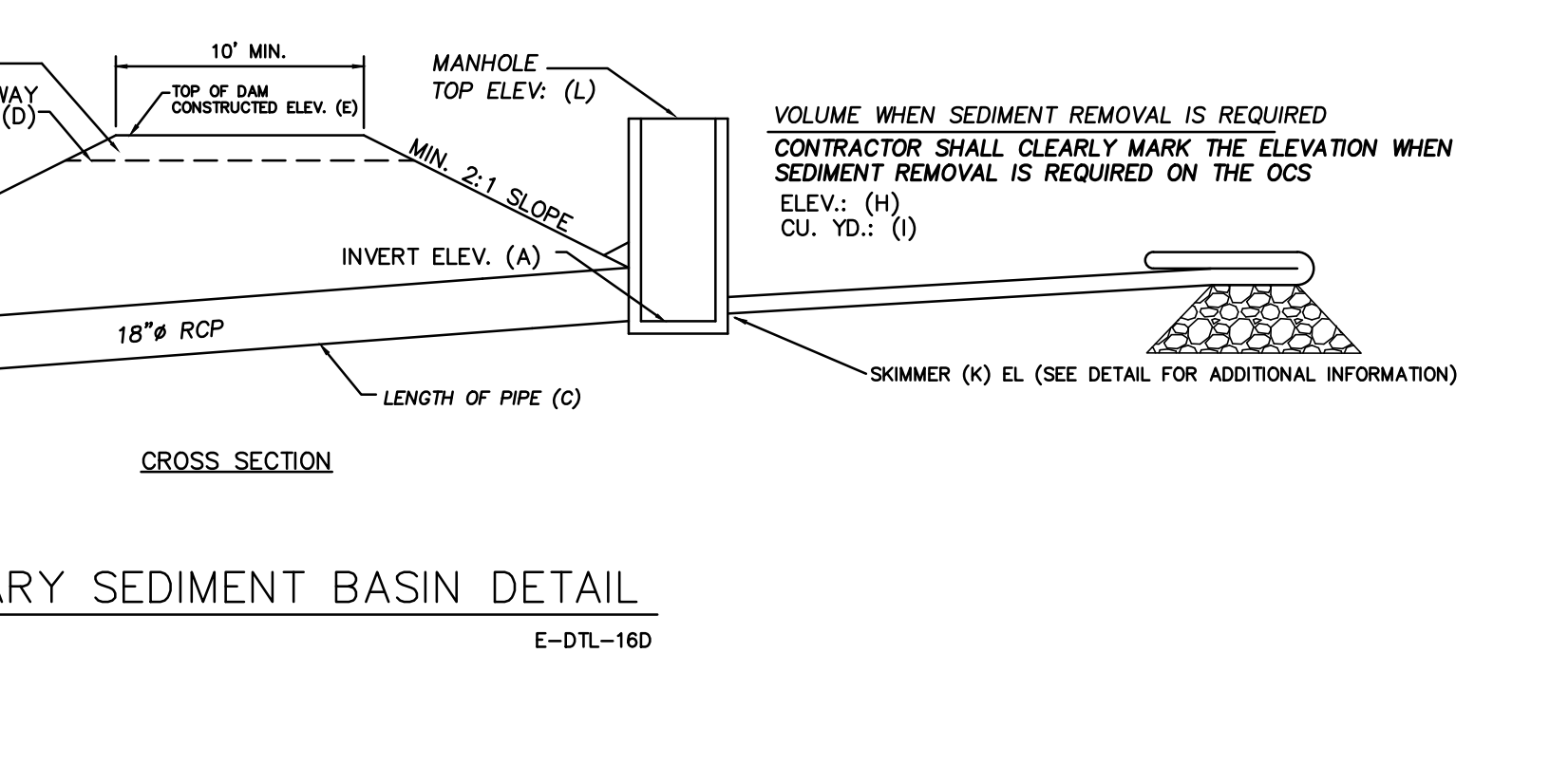
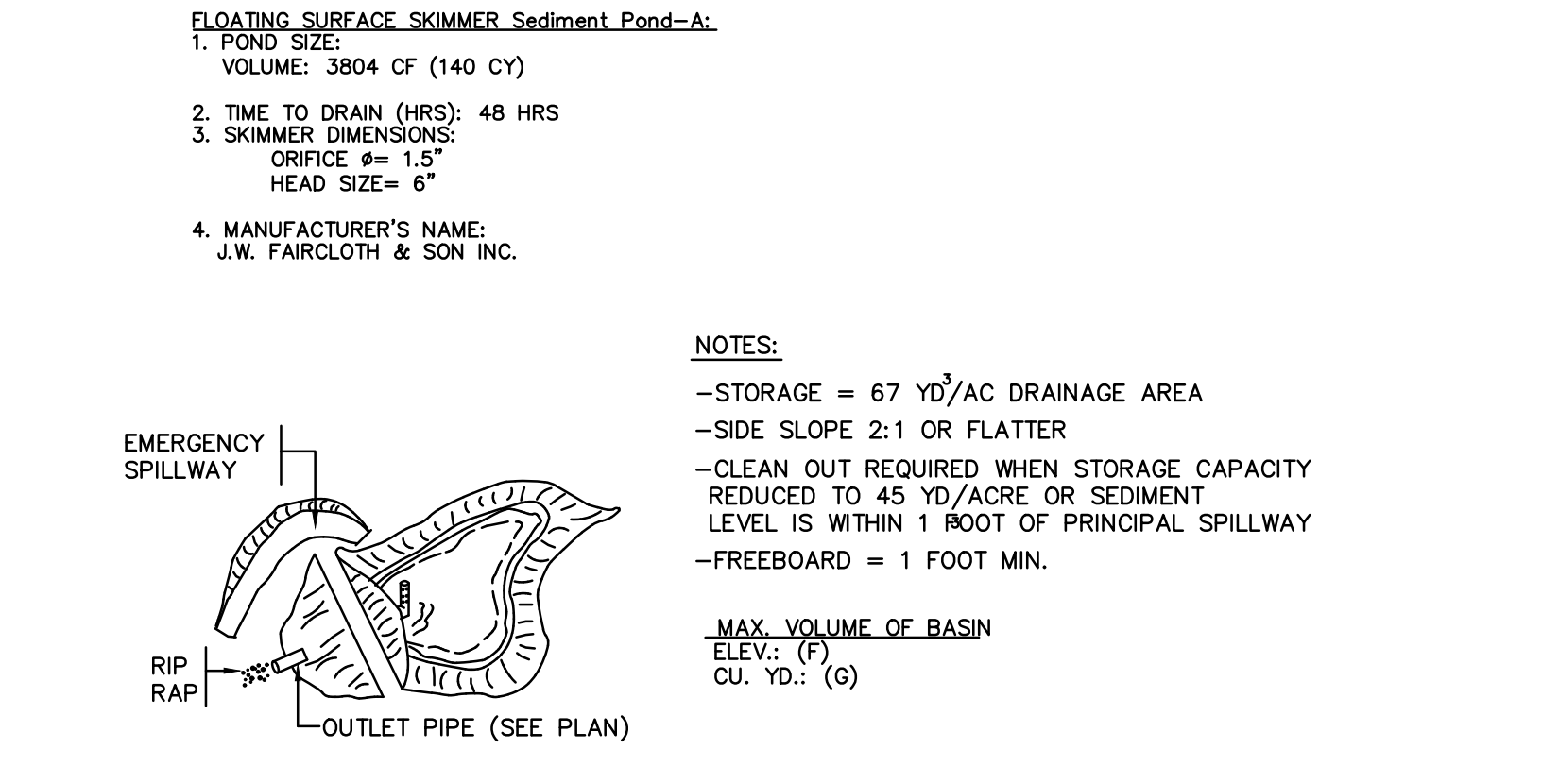
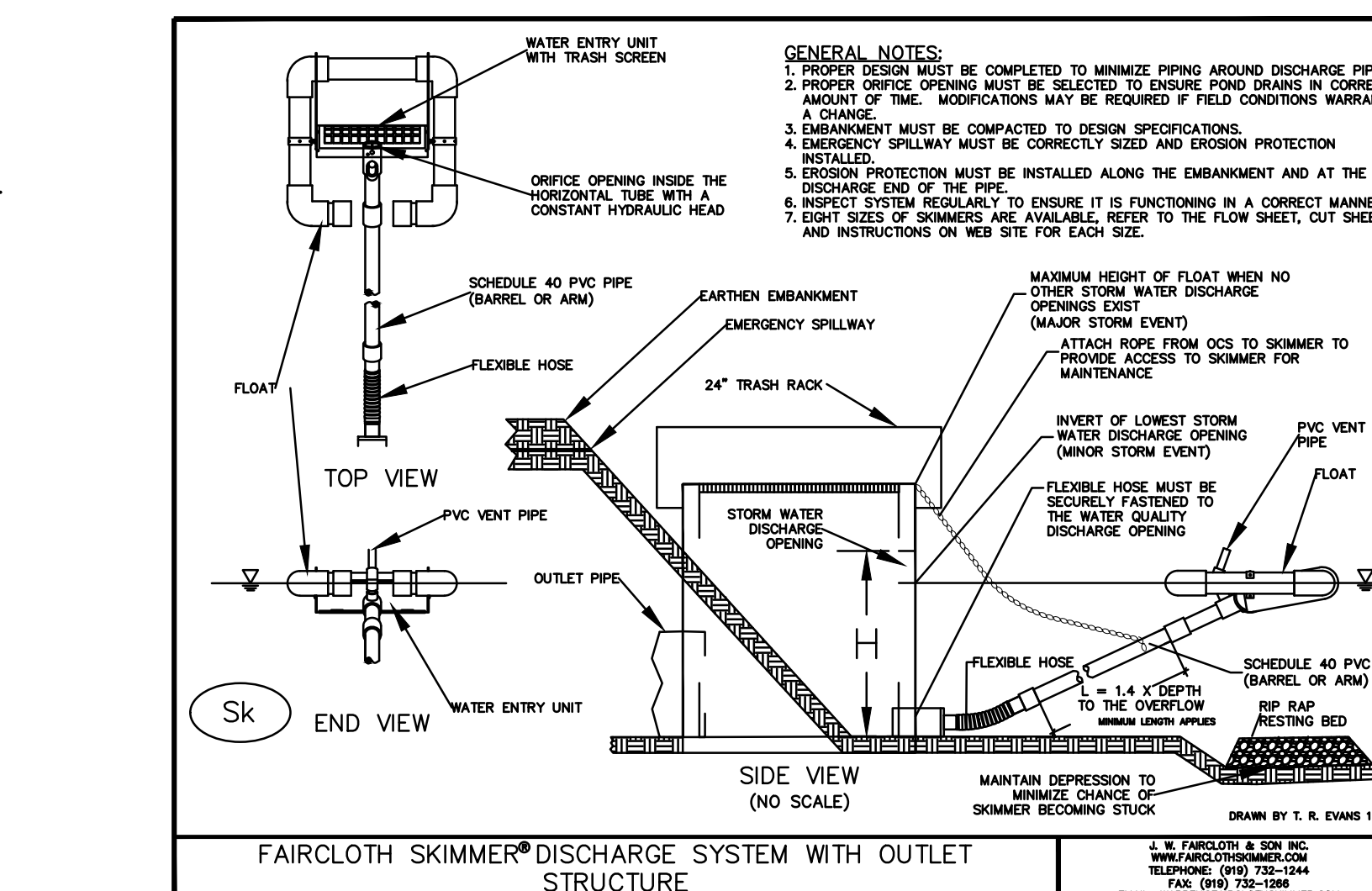
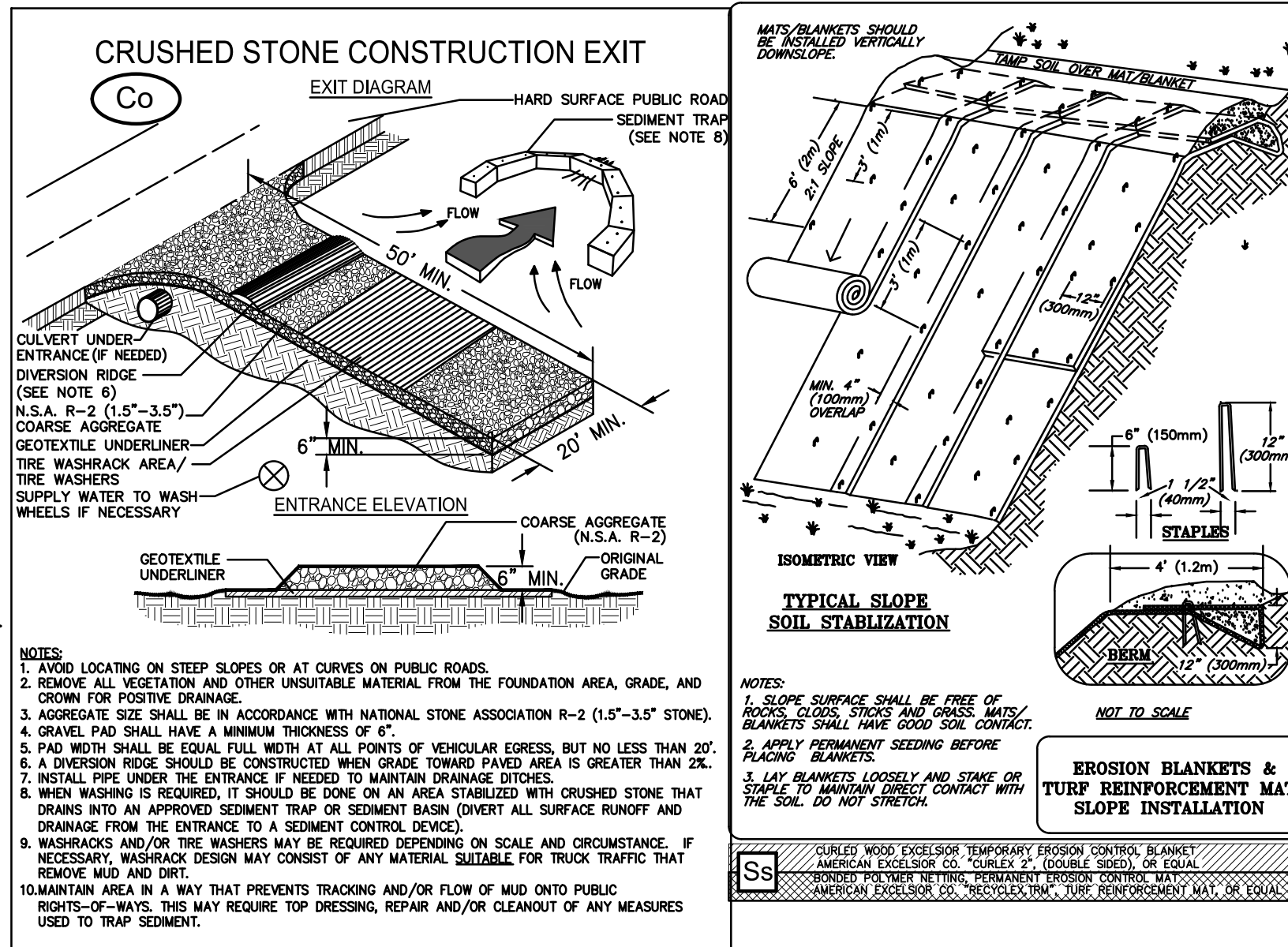

PREPARED BY:
HRC
HUGHES-RAY COMPANY, INC.
6554 EAST CHURCH STREET
DOUGLASVILLE, GEORGIA 30134
P 770.942.0196
F 770.942.0152
www.HughesRay.com

REVISION	PC COMMENTS	PC COMMENTS	PLANT MODIFICATION	LANDSCAPE MODIFICATION	ADDENDUM #1						
No.	DATE:	1	2/16/24	2	2/28/24	3	3/4/24	4	5/10/24	5	5/21/24

EROSION CONTROL STANDARD DETAILS
OF
HIRAM VETERAN'S MEMORIAL
CITY OF HIRAM, PAULDING COUNTY, GEORGIA
L.L. 753, 2nd DISTRICT, 3rd SECTION

OWNER:
CITY OF HIRAM

DEVELOPER:
JODY PALMER

24 HR. CONTACT:
CONTACT NAME
678.776.8929

REGISTERED PROFESSIONAL ENGINEER
DONALD H. THAN, P.E.
97 27 24

DATE: 02/28/24
DRAWN BY: DNW
CHECKED BY: JTT
JOB#: H23221
EC2

**SPEED
LIMIT
25**

PAVING HATCH LEGEND

NORMAL DUTY PAVING	STAMPED CONCRETE	NORMAL DUTY CONCRETE

SITE PLAN NOTES:
 1. ALL DIMENSIONS ARE TO FACE OF CURB
 2. ALL CURBS TO BE 24" CONCRETE CURB AND GUTTER UNLESS NOTED OTHERWISE.

REVISION No.	DATE	PC COMMENTS
1	2/16/24	PC COMMENTS
2	2/28/24	PC COMMENTS
3	3/4/24	PLANT MODIFICATION
4	5/10/24	LANDSCAPE MODIFICATION
5	5/21/24	ADDENDUM #1

**SITE PLAN OF
HIRAM VETERAN'S MEMORIAL**
 L.L. 753, 2nd DISTRICT, 3rd SECTION
 CITY OF HIRAM, PAULDING COUNTY, GEORGIA

OWNER:
CITY OF HIRAM

DEVELOPER:
JODY PALMER

24 HR. CONTACT:
CONTACT NAME
678.776.8929

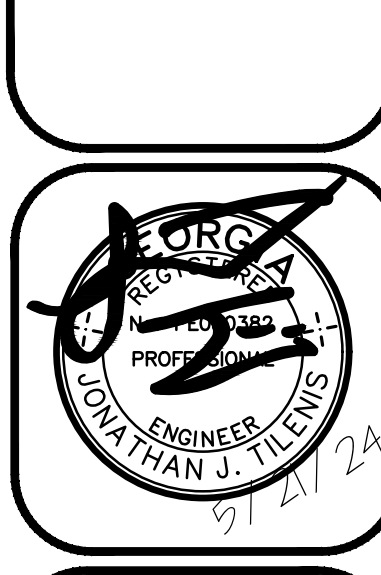

DATE: 02/28/24
 DRAWN BY: DNW
 CHECKED BY: JJT
JOB#: H23221
SP1

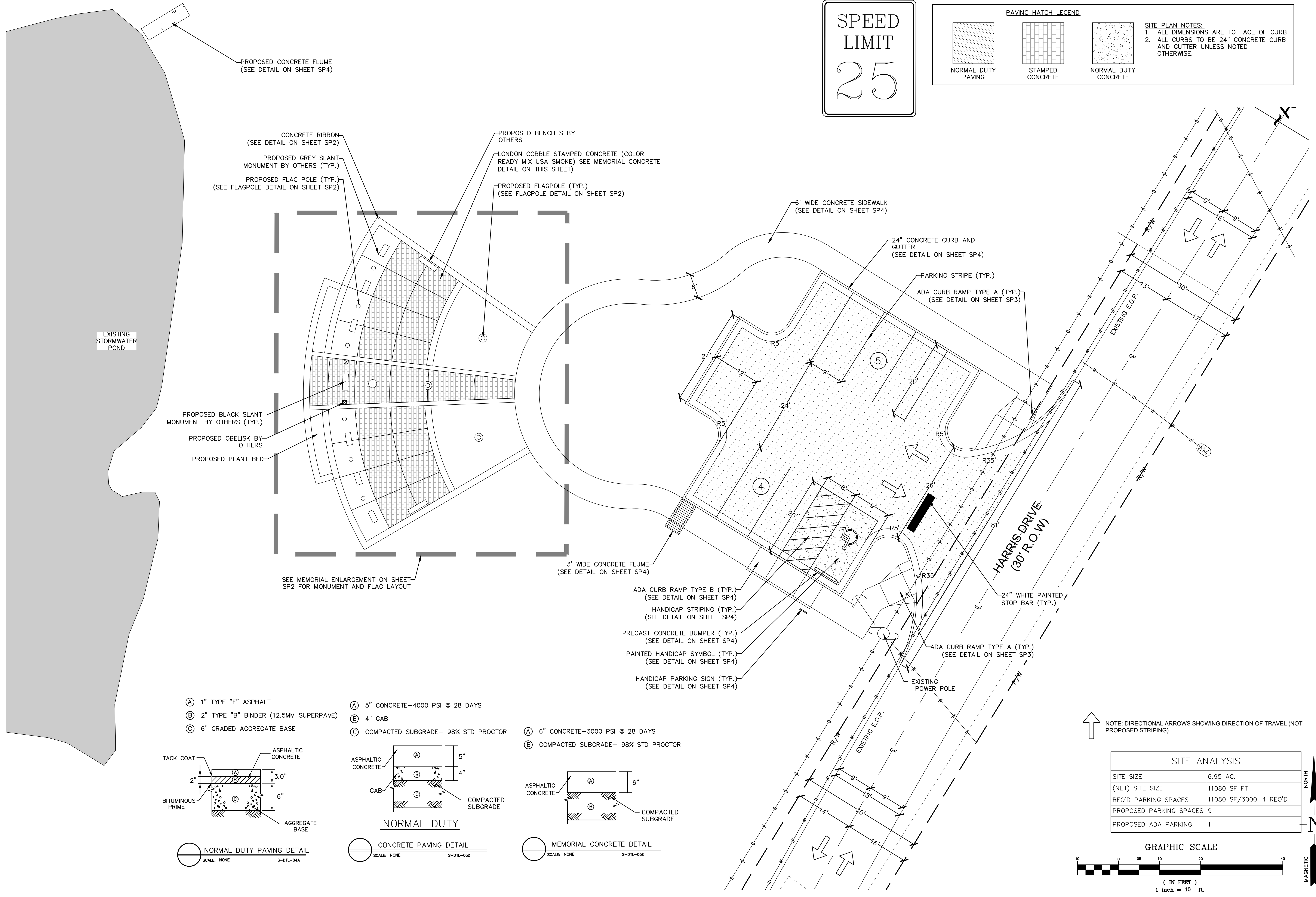

(A) 1" TYPE "F" ASPHALT	(A) 5" CONCRETE-4000 PSI @ 28 DAYS	(A) 6" CONCRETE-3000 PSI @ 28 DAYS
(B) 2" TYPE "B" BINDER (12.5MM SUPERPAVE)	(B) 4" GAB	(B) COMPACTED SUBGRADE- 98% STD PROCTOR
(C) 6" GRADED AGGREGATE BASE	(C) COMPACTED SUBGRADE- 98% STD PROCTOR	

NORMAL DUTY PAVING DETAIL
SCALE: NONE S-DTL-04A

CONCRETE PAVING DETAIL
SCALE: NONE S-DTL-05D

MEMORIAL CONCRETE DETAIL
SCALE: NONE S-DTL-05E

NOTE: DIRECTIONAL ARROWS SHOWING DIRECTION OF TRAVEL (NOT PROPOSED STRIPING)

SITE ANALYSIS	
SITE SIZE	6.95 AC.
(NET) SITE SIZE	11080 SF FT
REQ'D PARKING SPACES	11080 SF/3000=4 REQ'D
PROPOSED PARKING SPACES	9
PROPOSED ADA PARKING	1

GRAPHIC SCALE
 (IN FEET)
 1 inch = 10 ft.

MAGNETIC NORTH

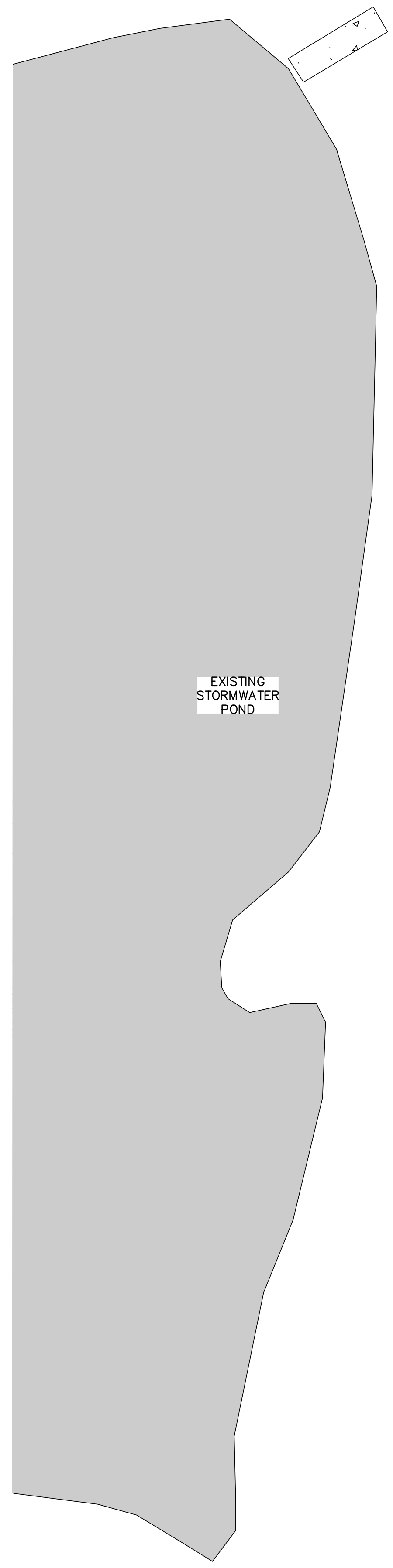

SPEED
LIMIT
25

PAVING HATCH LEGEND

NORMAL DUTY PAVING	STAMPED CONCRETE	NORMAL DUTY CONCRETE

SITE PLAN NOTES:
 1. ALL DIMENSIONS ARE TO FACE OF CURB
 2. ALL CURBS TO BE 24" CONCRETE CURB AND GUTTER UNLESS NOTED OTHERWISE.

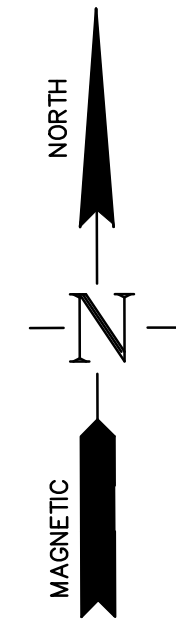
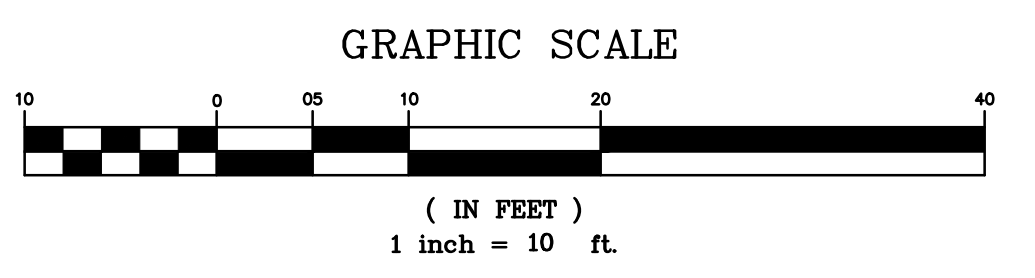
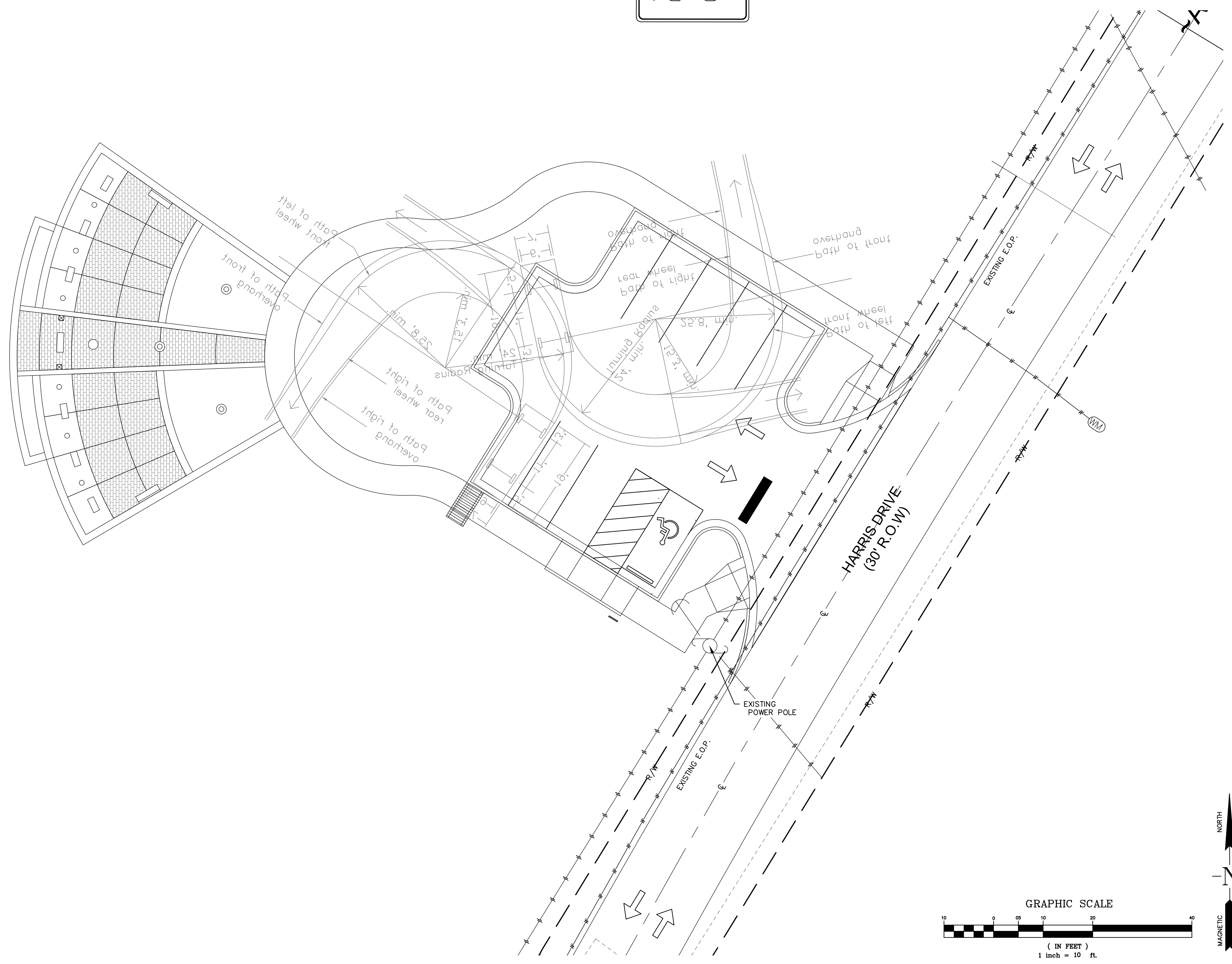

PREPARED BY:
HRC
 HUGHES-RAY COMPANY, INC.
 6554 EAST CHURCH STREET
 DOUGLASVILLE, GEORGIA 30134
 P 770.942.0196
 F 770.942.0152
 www.HughesRay.com

NO.	DATE:	REVISION
1	2/16/24	PC COMMENTS
2	2/28/24	PC COMMENTS
3	3/4/24	PLANT MODIFICATION
4	5/10/24	LANDSCAPE MODIFICATION
Δ	5/21/24	ADDENDUM #1

TURNING RADIUS PLAN
 OF
HIRAM VETERAN'S MEMORIAL
 L.L. 753, 2nd DISTRICT, 3rd SECTION
 CITY OF HIRAM, PAULDING COUNTY, GEORGIA

OWNER:
CITY OF HIRAM

DEVELOPER:
JODY PALMER

24 HR. CONTACT:
CONTACT NAME
678.776.8929

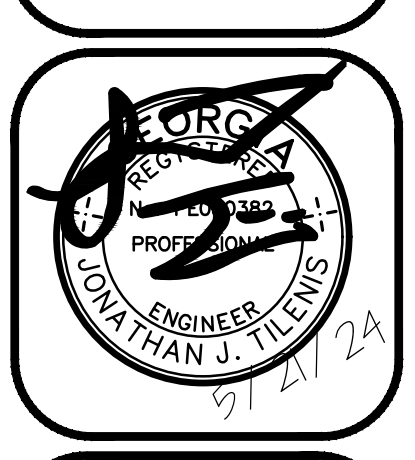

DATE: 02/28/24
 DRAWN BY: DNW
 CHECKED BY: JJT
 JOB#: H23221
SP5

REVISION	DATE	PC COMMENTS
No. 1	2/16/24	PC COMMENTS
2	2/28/24	PC COMMENTS
3	3/4/24	PLANT MODIFICATION
4	5/10/24	LANDSCAPE MODIFICATION
ADDENDUM #1	5/21/24	

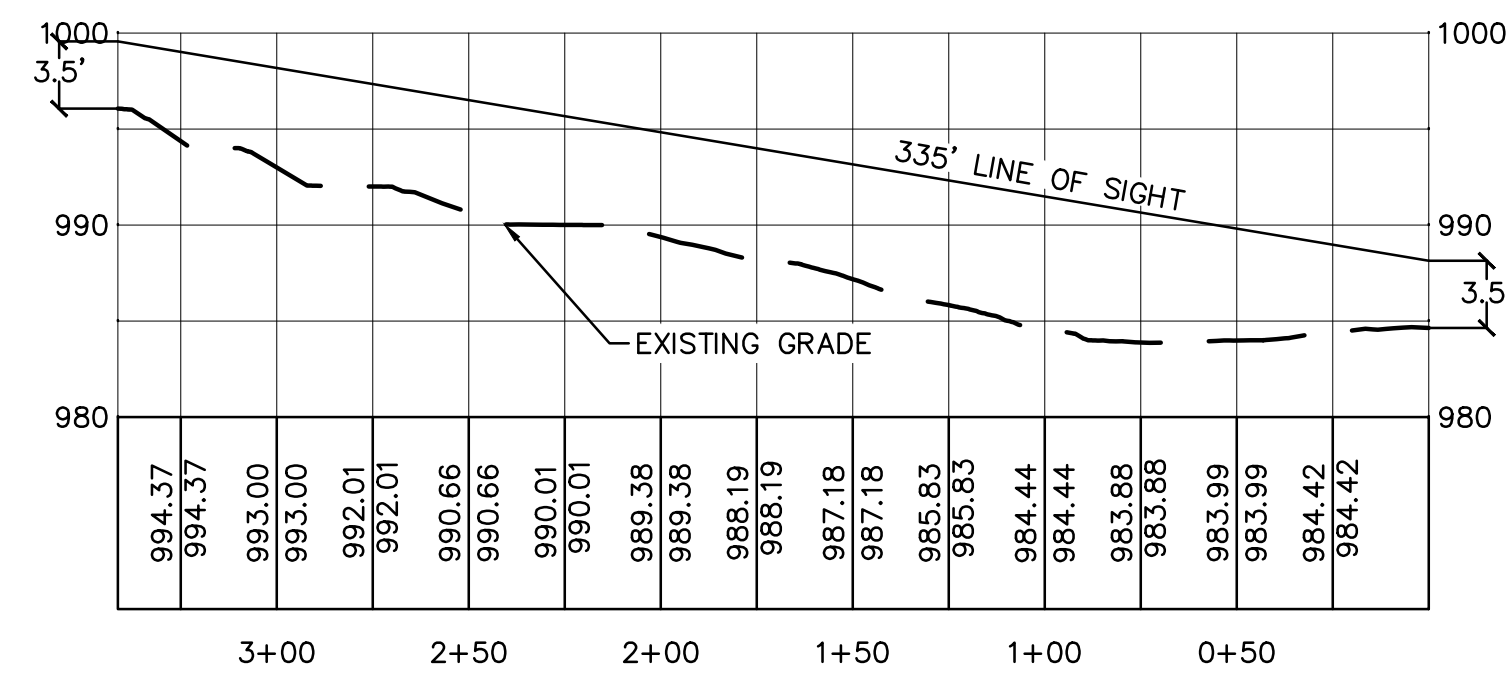

SIGHT DISTANCE LEFT
 VERT. SCALE 1"=10'
 HORIZ. SCALE 1"=50'

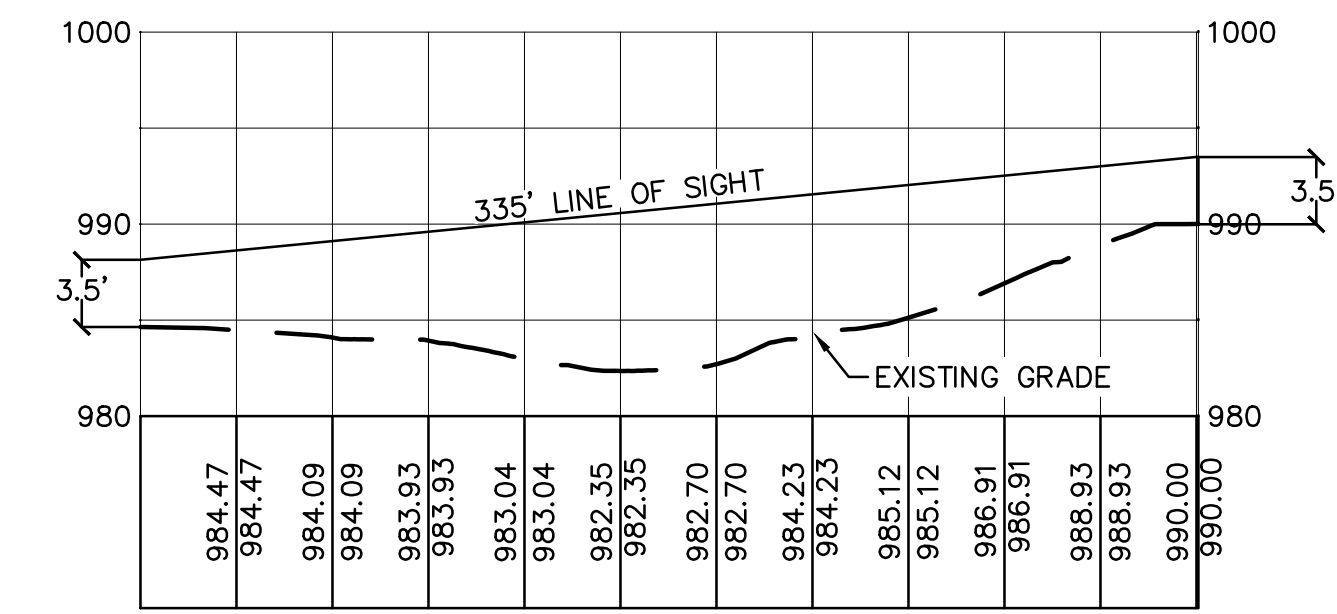

SIGHT DISTANCE RIGHT
 VERT. SCALE 1"=10'
 HORIZ. SCALE 1"=50'

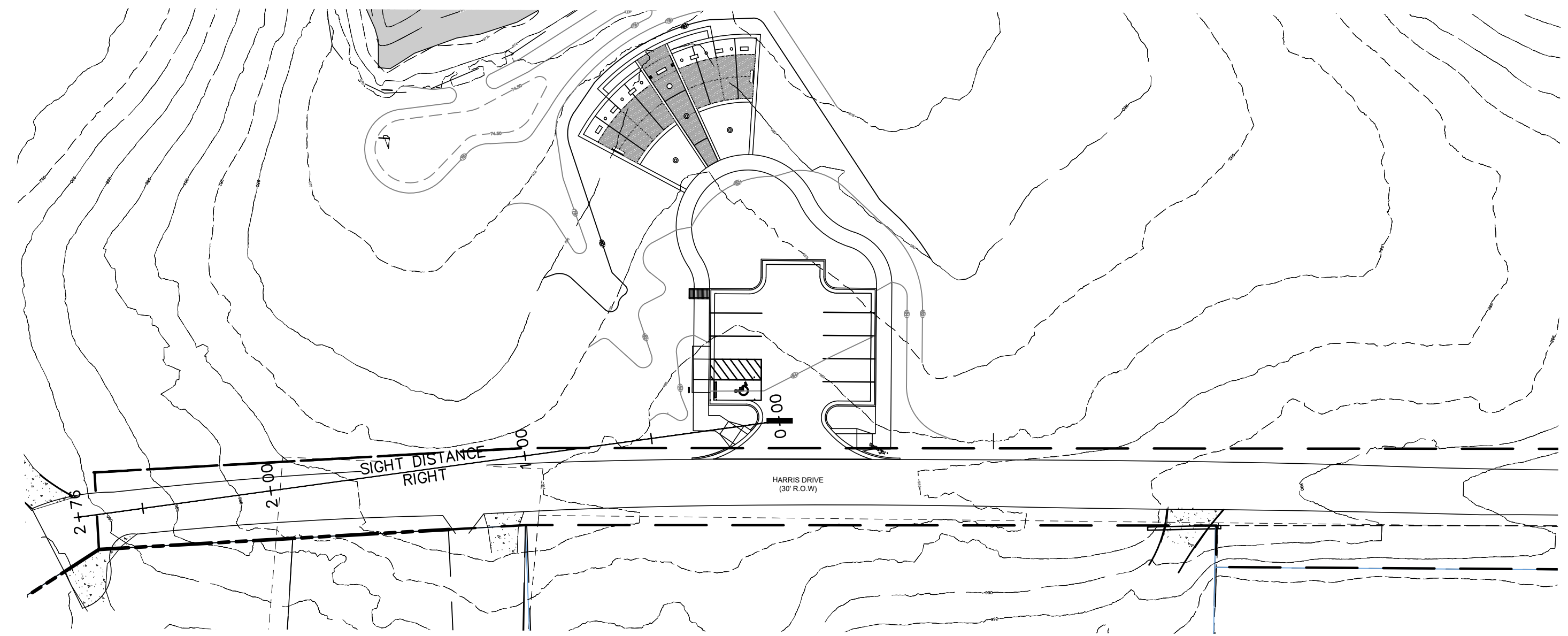
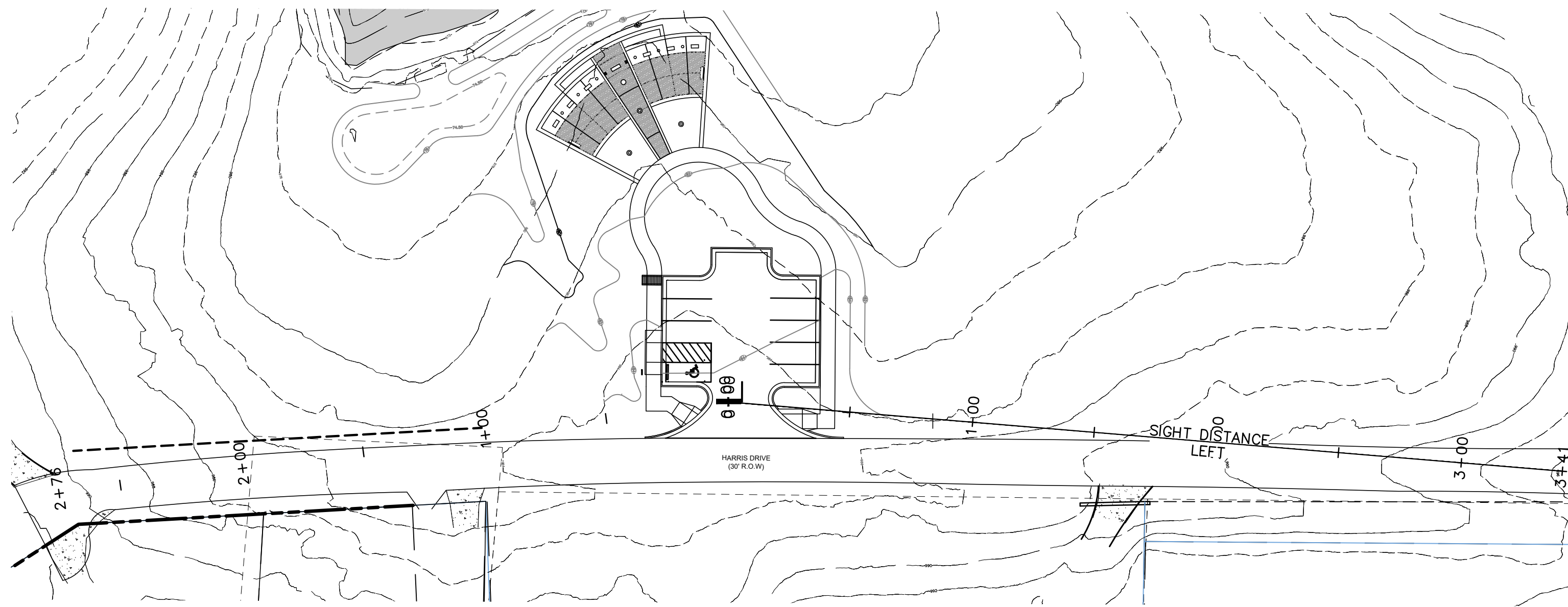

SIGHT DISTANCE PLAN & PROFILE

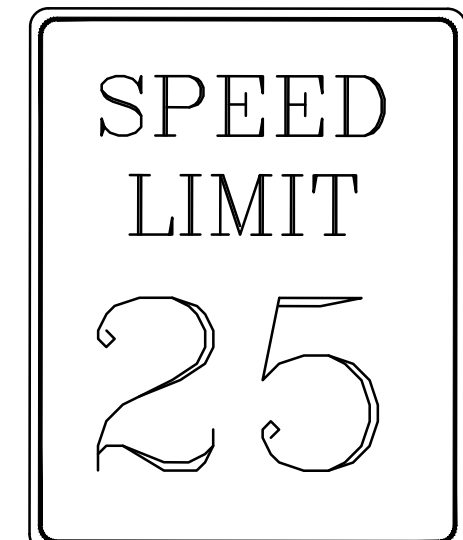

SIGHT DISTANCE PLAN AND PROFILE
 OF
HIRAM VETERAN'S MEMORIAL
 L.L. 753, 2nd DISTRICT, 3rd SECTION
 CITY OF HIRAM, PAULDING COUNTY, GEORGIA

OWNER:
CITY OF HIRAM
 DEVELOPER:
JODY PALMER
 24 HR. CONTACT:
CONTACT NAME
678.776.8929

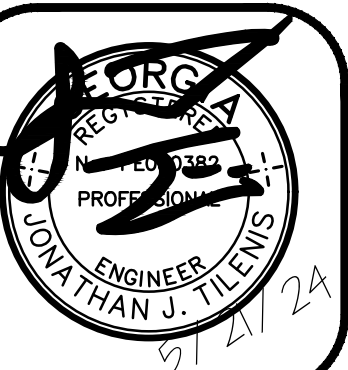

DATE: 02/28/24
 DRAWN BY: DNW
 CHECKED BY: JJT

JOB#: H23221
SDP

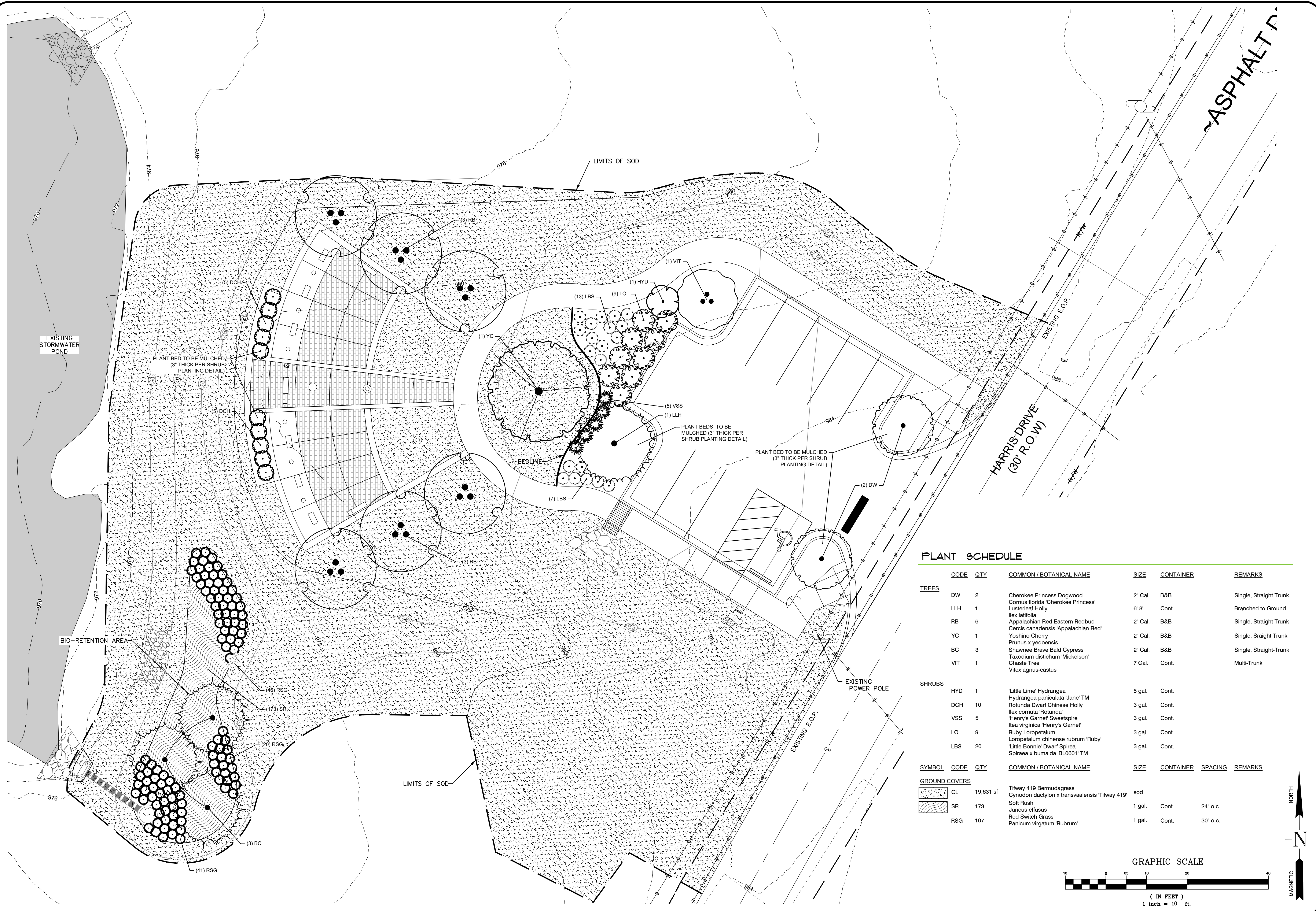

NO.	DATE	REVISION
1	2/16/24	PC COMMENTS
2	2/28/24	PC COMMENTS
3	3/4/24	PLANT MODIFICATION
4	5/10/24	LANDSCAPE MODIFICATION
5	5/21/24	ADDENDUM #1

LANDSCAPING PLAN
 OF
HIRAM VETERAN'S MEMORIAL
 L.L. 753, 2nd DISTRICT, 3rd SECTION
 CITY OF HIRAM, PAULDING COUNTY, GEORGIA

OWNER:
 CITY OF HIRAM
 DEVELOPER:
 JODY PALMER
 24 HR. CONTACT:
 CONTACT NAME
 678.776.8929

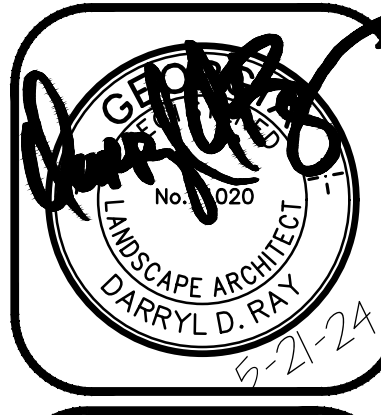

DATE: 02/28/24
 DRAWN BY: DNW
 CHECKED BY: JJT
 JOB#: H23221
LA1

PLANT SCHEDULE

	CODE	QTY	COMMON / BOTANICAL NAME	SIZE	CONTAINER	REMARKS
TREES						
	DW	2	Cherokee Princess Dogwood Cornus florida 'Cherokee Princess'	2' Cal.	B&B	Single, Straight Trunk
	LLH	1	Lusterleaf Holly Ilex latifolia	6'-8'	Cont.	Branched to Ground
	RB	6	Appalachian Red Eastern Redbud Cercis canadensis 'Appalachian Red'	2' Cal.	B&B	Single, Straight Trunk
	YC	1	Yoshino Cherry Prunus x yedoensis	2' Cal.	B&B	Single, Straight Trunk
	BC	3	Shawnee Brave Bald Cypress Taxodium distichum 'Mickelson'	2' Cal.	B&B	Single, Straight-Trunk
	VIT	1	Chaste Tree Vitex agnus-castus	7 Gal.	Cont.	Multi-Trunk
SHRUBS						
	HYD	1	'Little Lime' Hydrangea Hydrangea paniculata 'Jane' TM	5 gal.	Cont.	
	DCH	10	Rotunda Dwarf Chinese Holly Ilex cornuta 'Rotunda'	3 gal.	Cont.	
	VSS	5	'Henry's Garnet' Sweetspire Itea virginica 'Henry's Garnet'	3 gal.	Cont.	
	LO	9	Ruby Loropetalum Loropetalum chinense rubrum 'Ruby'	3 gal.	Cont.	
	LBS	20	'Little Bonnie' Dwarf Spirea Spiraea x bumalda 'BL0601' TM	3 gal.	Cont.	
GROUND COVERS						
	CL	19,631 sf	Tifway 419 Bermudagrass Cynodon dactylon x transvaalensis 'Tifway 419'		sod	
	SR	173	Soft Rush Juncus effusus	1 gal.	Cont.	24" o.c.
	RSG	107	Red Switch Grass Panicum virgatum 'Rubrum'	1 gal.	Cont.	30" o.c.

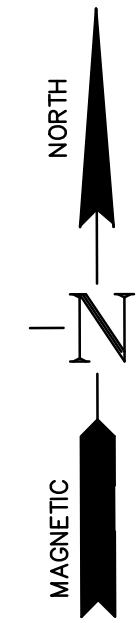
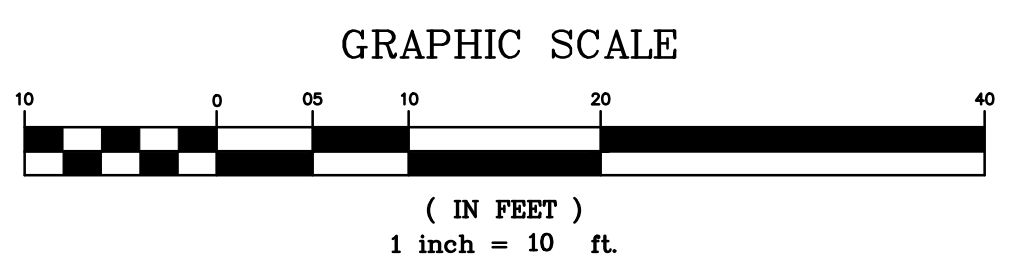

REVISION	DATE	NO.	COMMENTS
PC COMMENTS	2/16/24	1	
PC COMMENTS	2/28/24	2	
PLANT MODIFICATION	3/4/24	3	
LANDSCAPE MODIFICATION	5/10/24	4	
ADDENDUM #1	5/21/24	5	

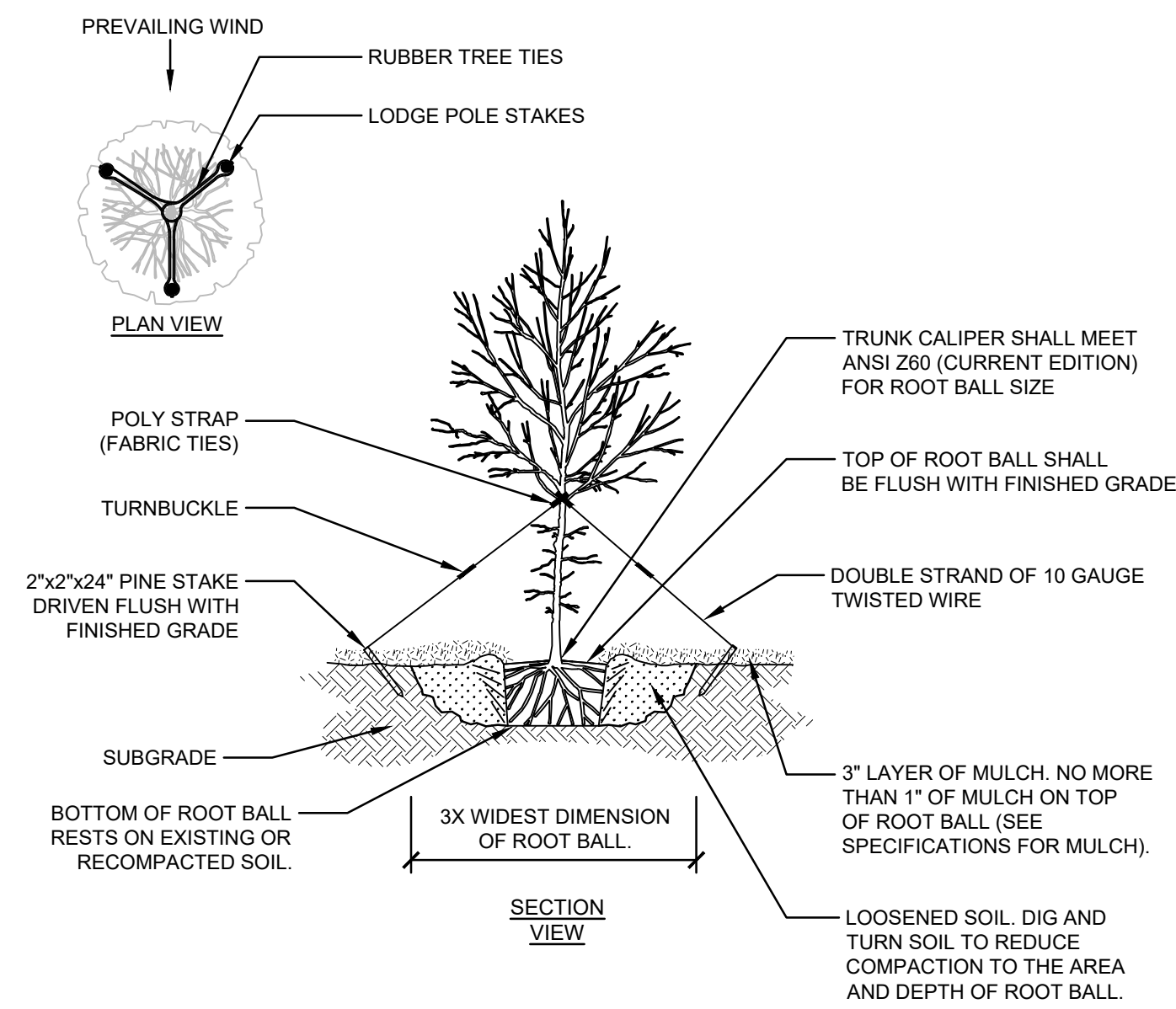

1 TREE PLANTING & STAKING DETAIL
 3/16" = 1'-0" HRC-LA-02

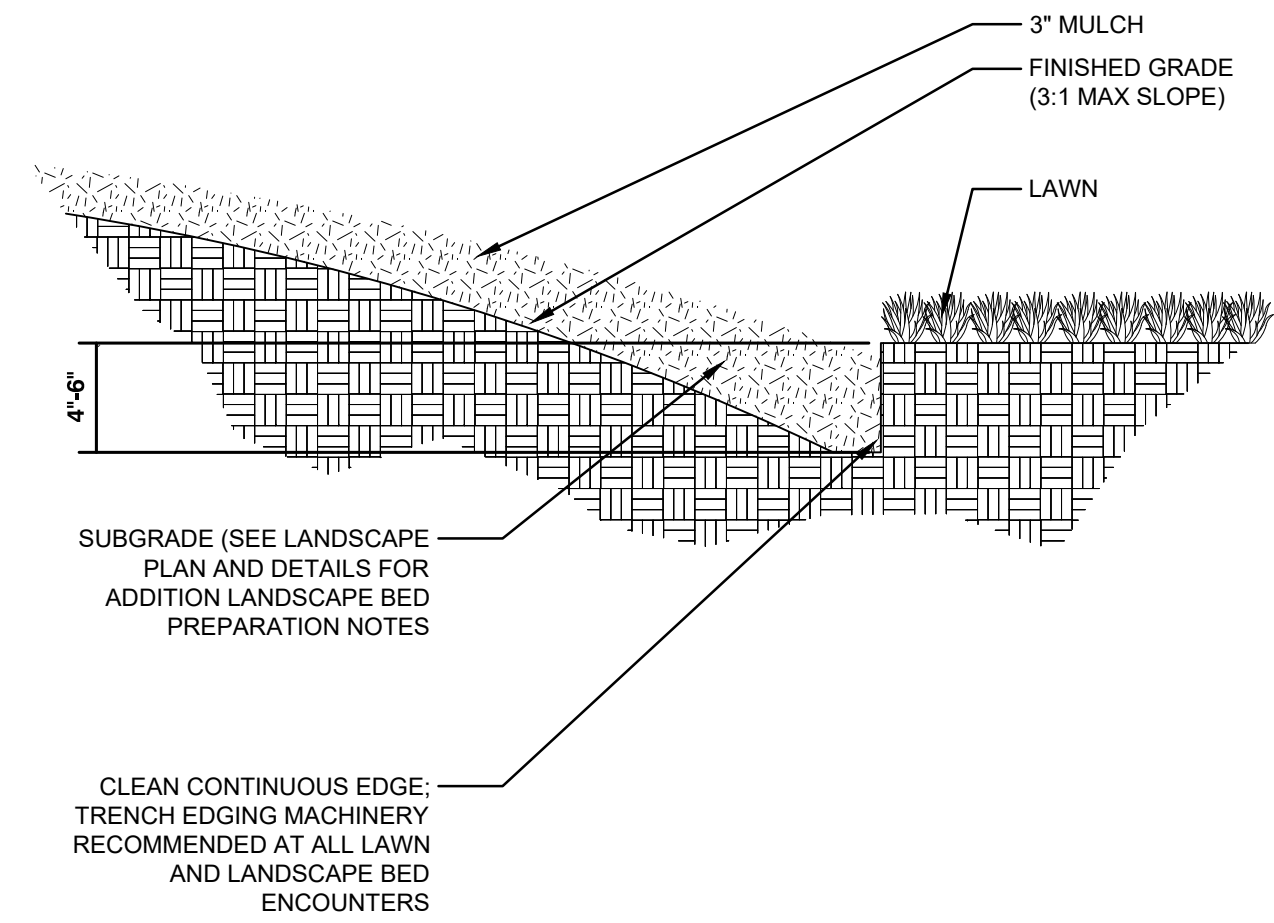

2 PLANTING BED EDGE DETAIL
 1/2" = 1'-0" HRC-LA-06

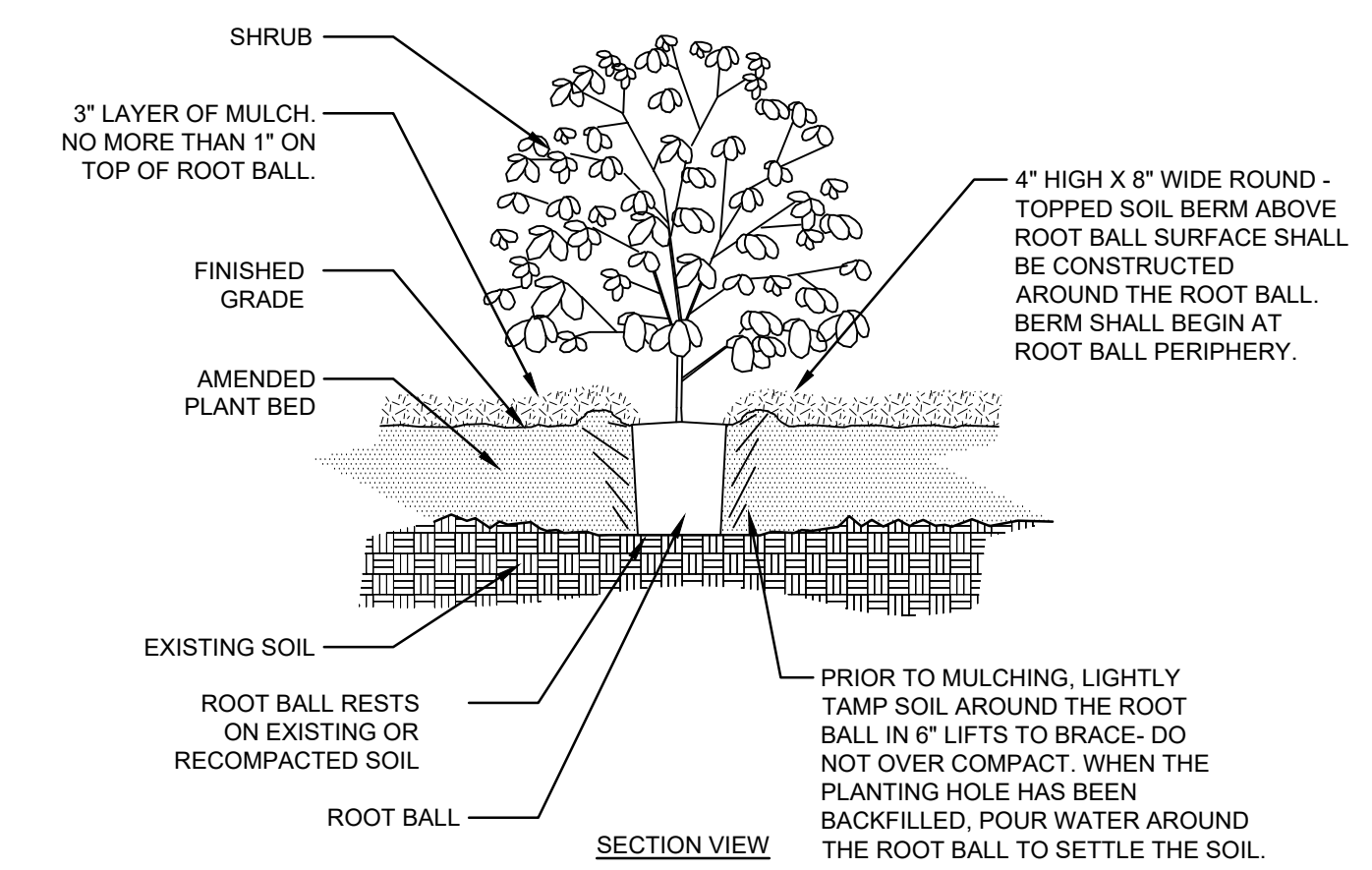

3 SHRUB PLANTING DETAIL
 3/16" = 1'-0" HRC-LA-07

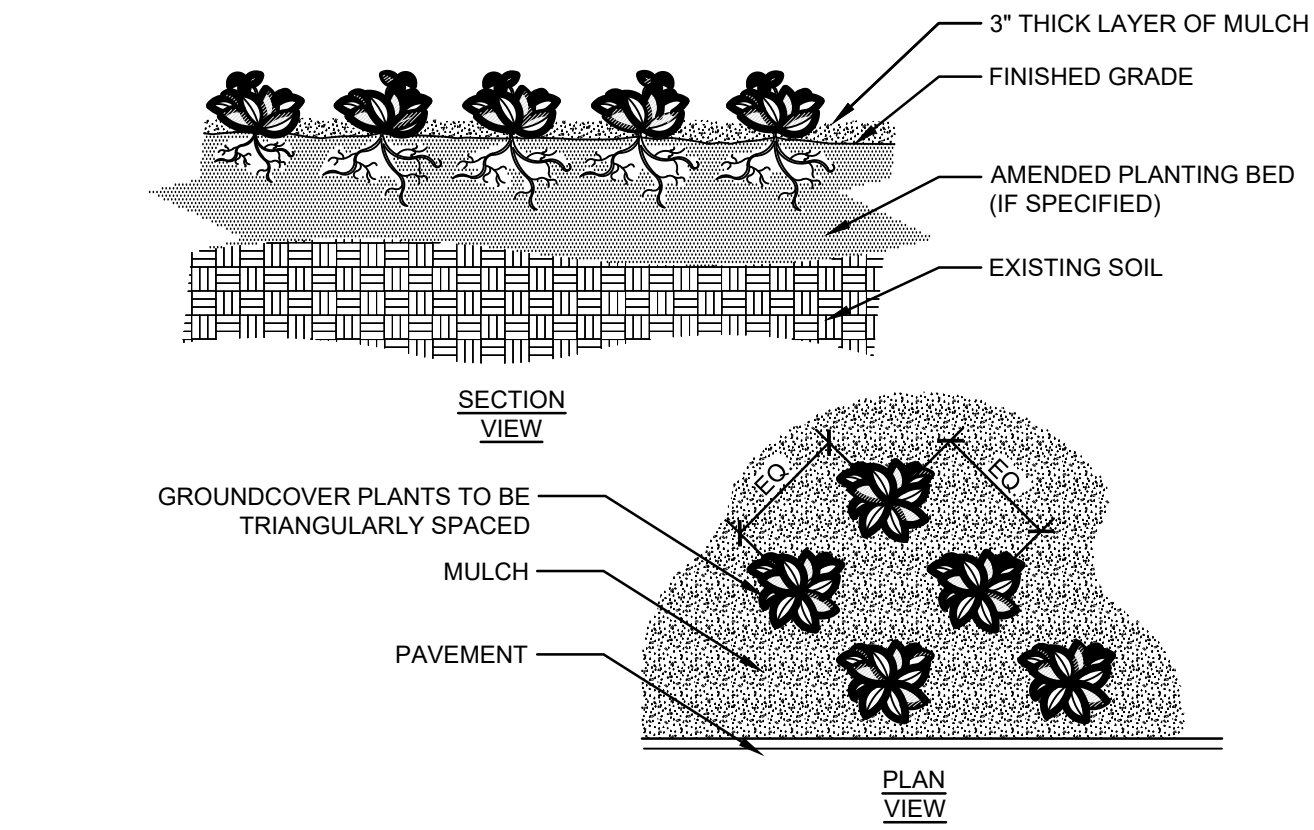

NOTES:

- 1- SEE PLANTING LEGEND FOR GROUNDCOVER SPECIES, SIZE AND SPACING DIMENSION.
- 2- SMALL ROOTS (1/4" OR LESS) THAT GROW AROUND, UP, OR DOWN THE ROOT BALL PERIPHERY ARE CONSIDERED A NORMAL CONDITION IN CONTAINER PRODUCTION AND ARE ACCEPTABLE, HOWEVER THEY SHOULD BE ELIMINATED AT THE TIME OF PLANTING. ROOTS ON THE PERIPHERY CAN BE REMOVED AT THE TIME OF PLANTING (SEE ROOT BALL SHAVING CONTAINER DETAIL).
- 3- SETTLE SOIL AROUND ROOT BALL OF EACH GROUNDCOVER PRIOR TO MULCHING.

4 GROUNDCOVER PLANTING DETAIL
 1/4" = 1'-0" HRC-LA-03

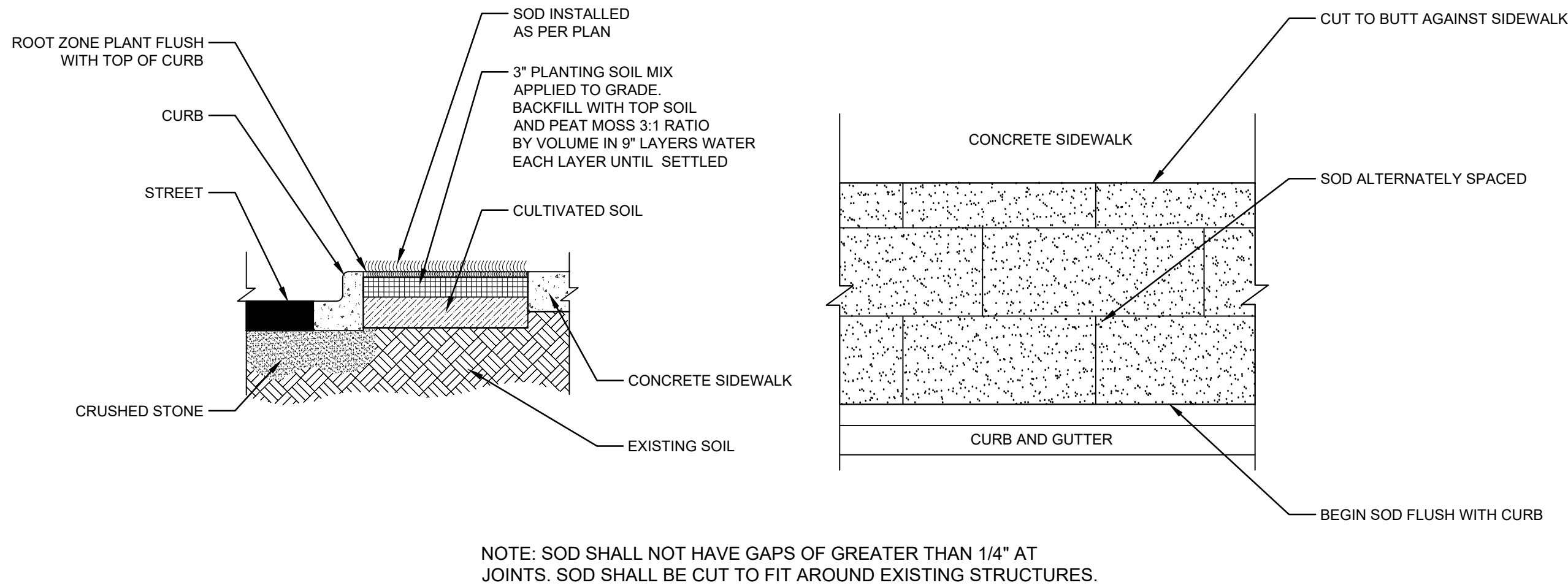

5 SOD PLACEMENT DETAIL
 1/2" = 1'-0" HRC-LA-04

NOTES:

1. ALL PLANTS MUST BE HEALTHY, VIGOROUS MATERIAL, FREE OF PESTS & DISEASE.
2. ALL PLANTS MUST BE CONTAINER GROWN OR BALLED & BURLAPPED AS INDICATED IN PLANT LIST.
3. ALL TREES MUST BE STRAIGHT TRUNKED, FULL HEADED & MEET ALL REQUIREMENTS SPECIFIED.
4. ALL PLANTS ARE SUBJECT TO REJECTION BY THE LANDSCAPE ARCHITECT & THE OWNER BEFORE, DURING & AFTER INSTALLATION.
5. ALL TREES MUST BE GUYED OR STAKED AS SHOWN IN THE DETAILS.
6. ALL PLANTS & PLANT BEDS MUST BE COMPLETELY MULCHED AS SPECIFIED.
7. PRIOR TO CONSTRUCTION, THE LANDSCAPE CONTRACTOR IS RESPONSIBLE FOR LOCATING ALL UNDERGROUND UTILITIES & SHALL AVOID DAMAGE TO ALL UTILITIES DURING THE COURSE OF THE LANDSCAPE CONSTRUCTION.
8. THE LANDSCAPE CONTRACTOR IS RESPONSIBLE FOR VERIFYING ALL QUANTITIES SHOWN ON THESE PLANS, BEFORE PRICING THE WORK.
9. THE LANDSCAPE CONTRACTOR IS RESPONSIBLE FOR MAINTAINING, IN FULL, ALL PLANTING (INCLUDING WATER, SPRAYING, MULCHING, MOWING, FERTILIZING, ETC.) OF PLANTING AREAS AND LAWNS UNTIL THE JOB IS ACCEPTED IN FULL, BY THE LANDSCAPE ARCHITECT & THE OWNER.
10. THE OWNER WILL CONTRACT FOR A PROGRAM OF LANDSCAPE MAINTENANCE SERVICES THROUGHOUT THE ONE (1) YEAR GUARANTEE PERIOD UNLESS OTHERWISE DETERMINED.
11. THE LANDSCAPE CONTRACTOR SHALL COMPLETELY GUARANTEE ALL PLANT MATERIAL FOR A PERIOD OF ONE (1) YEAR BEGINNING AT THE DATE OF TOTAL ACCEPTANCE AND SHALL PROMPTLY MAKE ALL REPLACEMENTS BEFORE OR AT THE END OF THE GUARANTEE PERIOD (AS PER DIRECTION OF THE LANDSCAPE ARCHITECT).
12. THE LANDSCAPE ARCHITECT WILL APPROVE THE STAKED LOCATION OF ALL PLANT MATERIAL PRIOR TO INSTALLATION.
13. DO NOT ALLOW AIR POCKETS TO FORM WHEN BACKFILLING.
14. WATER TREES AFTER PLANTING.
15. MAINTAIN ORIGINAL GRADE OR SLIGHTLY ABOVE GRADE AT THE TREE BASE.
16. PAINT ALL CUTS AND SCRAPES 1/2" IN DIAMETER WITH PRUNING PAINT.
17. DO NOT BREAK ROOT BALL.
18. SET TRUNK PLUMB.
19. AFTER BEING DUG AT THE NURSERY SOURCE, ALL TREES IN LEAF SHALL BE ACCLIMATED FOR TWO WEEKS UNDER A MIST SYSTEM PRIOR TO INSTALLATION. ANY PLANT MATERIAL WHICH DIES, TURNS BROWN, DEFOLIATES OR FAILS TO GERMINATE
20. PRIOR TO TOTAL ACCEPTANCE OF THE WORK SHALL BE PROMPTLY REMOVED FROM THE SITE & REPLACED WITH MATERIAL OF THE SAME SPECIES, QUANTITY, SIZE AND MEETING ALL PLANT LIST SPECIFICATIONS.
21. STANDARDS SET FORTH IN "AMERICAN STANDARDS FOR NURSERY STOCK" REPRESENT GUIDELINE SPECIFICATIONS ONLY AND CONSTITUTE MINIMUM QUALITY REQUIREMENTS FOR PLANT MATERIAL OF THE SAME SPECIES, QUANTITY, SIZE AND MEETING ALL PLANT LIST SPECIFICATIONS.

6 GENERAL LANDSCAPE NOTES
 HRC-LA-01

LANDSCAPE NOTES AND DETAILS
 OF
HIRAM VETERAN'S MEMORIAL
 L.L. 753, 2nd DISTRICT, 3rd SECTION
 CITY OF HIRAM, PAULDING COUNTY, GEORGIA

OWNER:
 CITY OF HIRAM
 DEVELOPER:
 JODY PALMER
 24 HR. CONTACT:
 CONTACT NAME
 678.776.8929

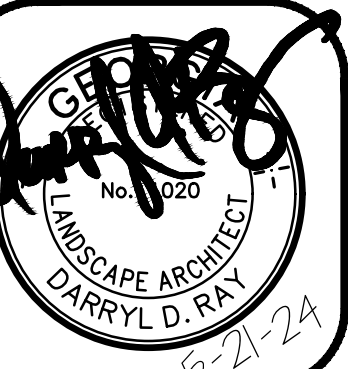

DATE: 02/28/24
 DRAWN BY: DNW
 CHECKED BY: JJT

JOB#: H23221
LA2

PANEL A																					
VOLTAGE: 120/240V, 1PH, 3W					TOTAL LOAD: 0.3 KVA					SURFACE MAIN BREAKER: 50A ENCLOSURE: NEMA 3R					AIC: 22,000						
No.	SERVES	LOAD (KVA)						BRKR	PH	BRKR	LOAD (KVA)						SERVES	No.			
		LTG	RCPT	MTR	A/C	KITCH	MISC				TRIP	P	A	C	P	TRIP			MISC	KITCH	A/C
1	FLAG LIGHTS	0.30						20	1		0.30	1	20							SPARE	2
3	SPARE							20	1		0.00	1	20							SPARE	4
5	SPACE																			SPACE	6
* PANEL SHALL BE SERVICE ENTRANCE RATED										0.30	0.00	0.00	0.00	0.00	0.00	0.00	0.00	0.30	CONNECTED KVA	0.3	

GENERAL NOTES:

- ALL UNDERGROUND CONDUIT SHALL BE PVC SCHEDULE 40 WITH RIGID ELBOWS. CONDUIT INSTALLED UNDER ROADWAYS AND DRIVES SHALL BE GALVANIZED RIGID STEEL (GRS).
- ALL CONDUIT INSTALLED UNDER ROADWAYS OR MONUMENT CONCRETE SHALL BE INSTALLED PRIOR TO ANY PAVING OR POURING OF CONCRETE. NO NEW PAVING OR CONCRETE SHALL BE CUT TO INSTALL ELECTRICAL LINES.
- CONTRACTOR SHALL ROUTE ALL CONDUITS RUNS BETWEEN EACH FLAG POLE TO THE HANDHOLE IN THE MOST DIRECT ROUTE POSSIBLE.
- ANY DAMAGE TO EXISTING UTILITIES SHALL BE REPAIRED BY THE CONTRACTOR AT NO ADDITIONAL COST TO THE CLIENT. THE CONTRACTOR SHALL VERIFY THE LOCATION OF ALL UNDERGROUND UTILITIES PRIOR TO ANY DIGGING.
- THE CONTRACTOR SHALL INSTALL A NYLON PULL CORD OR GALVANIZED PULL WIRE IN EACH SPARE CONDUIT.
- ALL FUSES AND FUSE HOLDERS SHALL BE IN-LINE TYPE, WATERPROOF AND PROVIDE WITH BREAKAWAY WIRING CONNECTORS. PROVIDE LABELS ON EACH FUSE IDENTIFYING FLAGPOLE. PROVIDE INDIVIDUAL 120V/2A FUSE FOR EACH FLAG POLE LIGHT IN HANDHOLE.
- FLAG POLES WILL BE PROVIDED WITH INTEGRAL LIGHT FIXTURES. INSTALL POLE AND LIGHT FIXTURE IN ACCORDANCE WITH MANUFACTURER'S INSTRUCTIONS.
- CONTRACTOR SHALL COORDINATE SERVICE (120/240V, 1PH, 3W) SERVICE TO THE SITE WITH THE LOCAL UTILITY COMPANY.

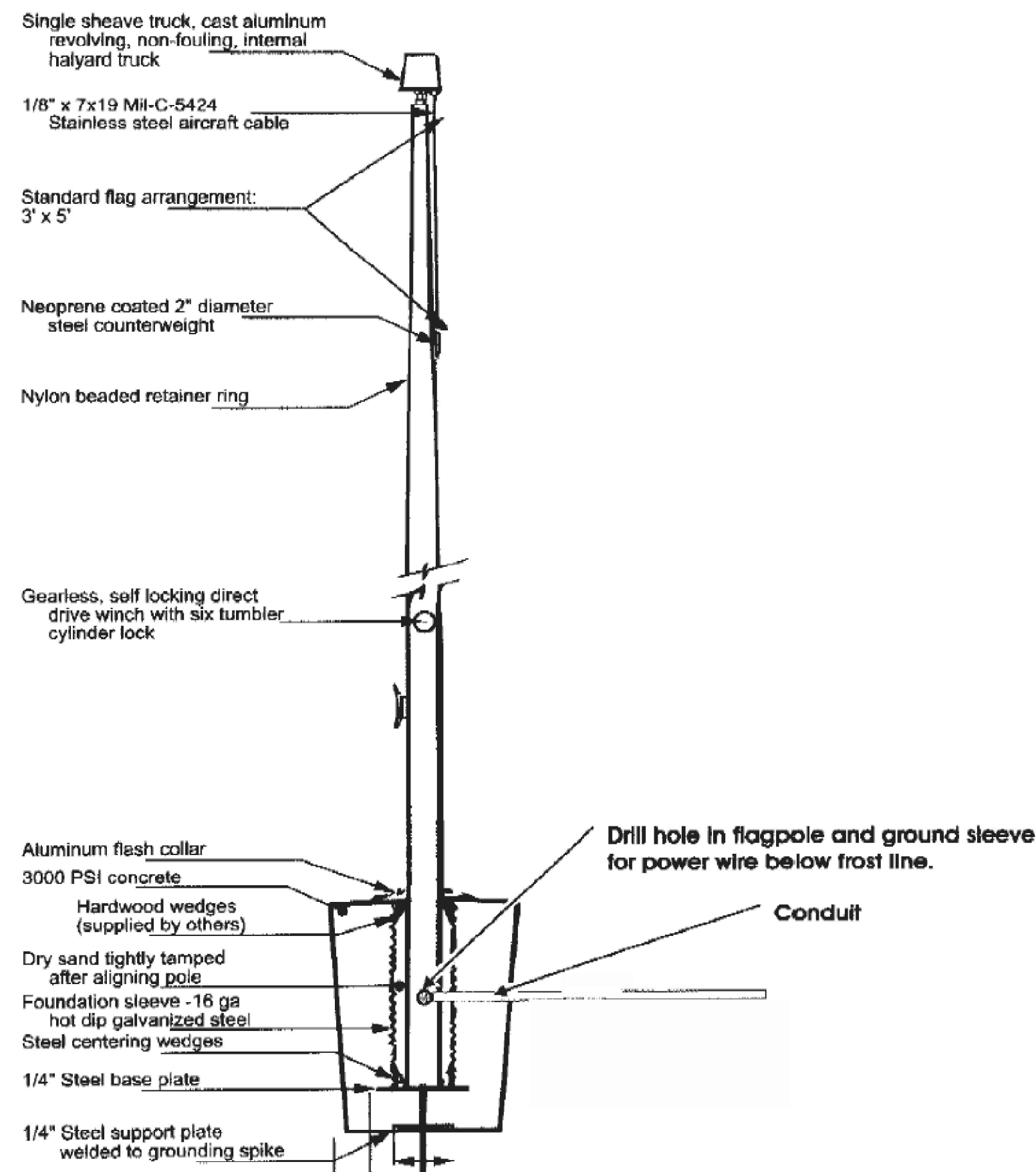

3 TYP. FLAG POLE DETAIL
E-1 SCALE: N.T.S.

SERVICE 'A' WIRING SCHEDULE

- 3 #6 IN 1" RGS C.
 - 1 #4G IN 3/4" PVC C
 - 1 #6
 - 1" RIGID AND 1" RIGID STEEL C ABOVE GRADE AND 1" PVC C AND 1" PVC C BELOW GRADE. SEE DRAWINGS FOR CONDUCTORS AND REQUIREMENTS.
 - 3 #6 & 1 #4 GND IN 1" RGS C.
 - 2#10 + 1#10G IN 3/4" RGS C
- ALL CONDUCTORS ARE TO BE COPPER

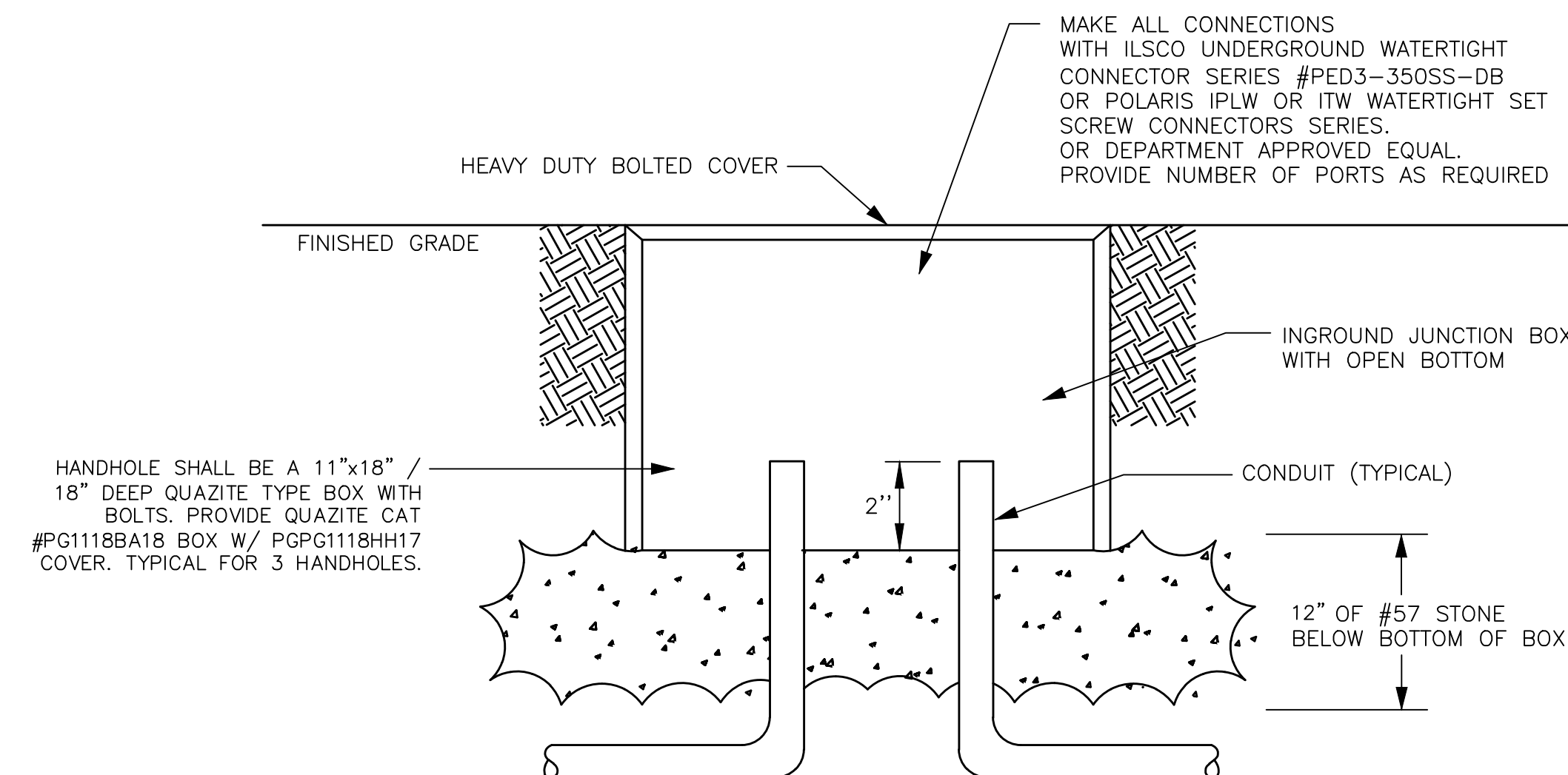

2 TYP. IN GROUND JB INSTALLATION DETAIL
E-1 SCALE: N.T.S.

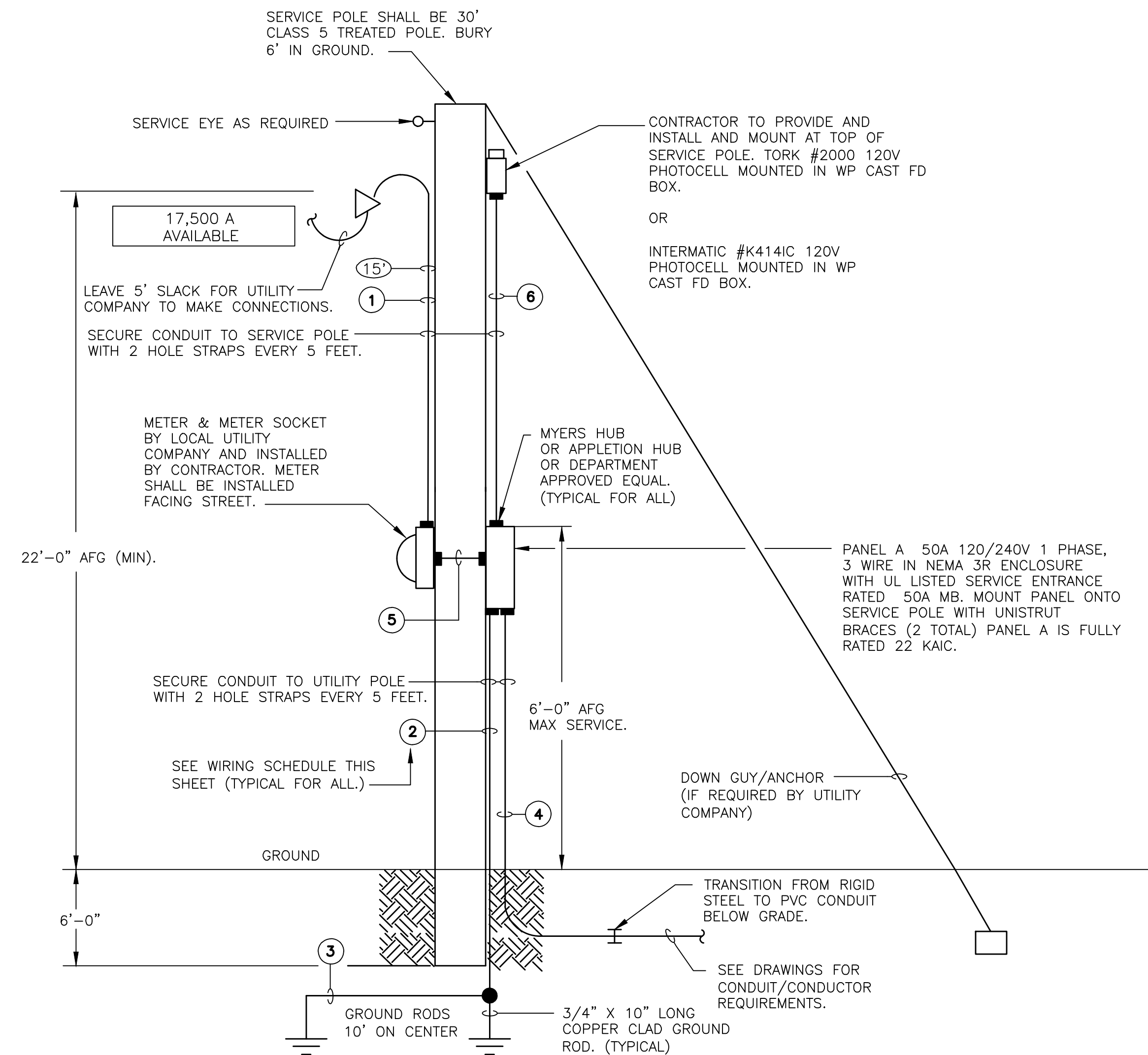

1 ONE LINE DIAGRAM SERVICE 'A'
E-1 SCALE: N.T.S.



REVISION	
No. DATE	

ELECTRICAL LEGEND AND DETAILS OF
HIRAM VETERAN'S MEMORIAL
L.L. 753, 2nd DISTRICT, 3rd SECTION
CITY OF HIRAM, PAULDING COUNTY, GEORGIA

OWNER:
CITY OF HIRAM

DEVELOPER:
JODY PALMER

24 HR. CONTACT:
CONTACT NAME
678.776.8929

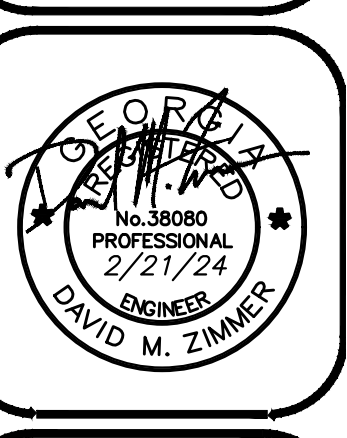

DATE: 02/21/24
DRAWN BY: AP
CHECKED BY: DMZ
JOB#: H23221
E-1

ESAD PROJECT #24007

ESAD LLC
885 WOODSTOCK ROAD
SUITE 430-231
ROSWELL, GA 30075
PH: 678-469-5196

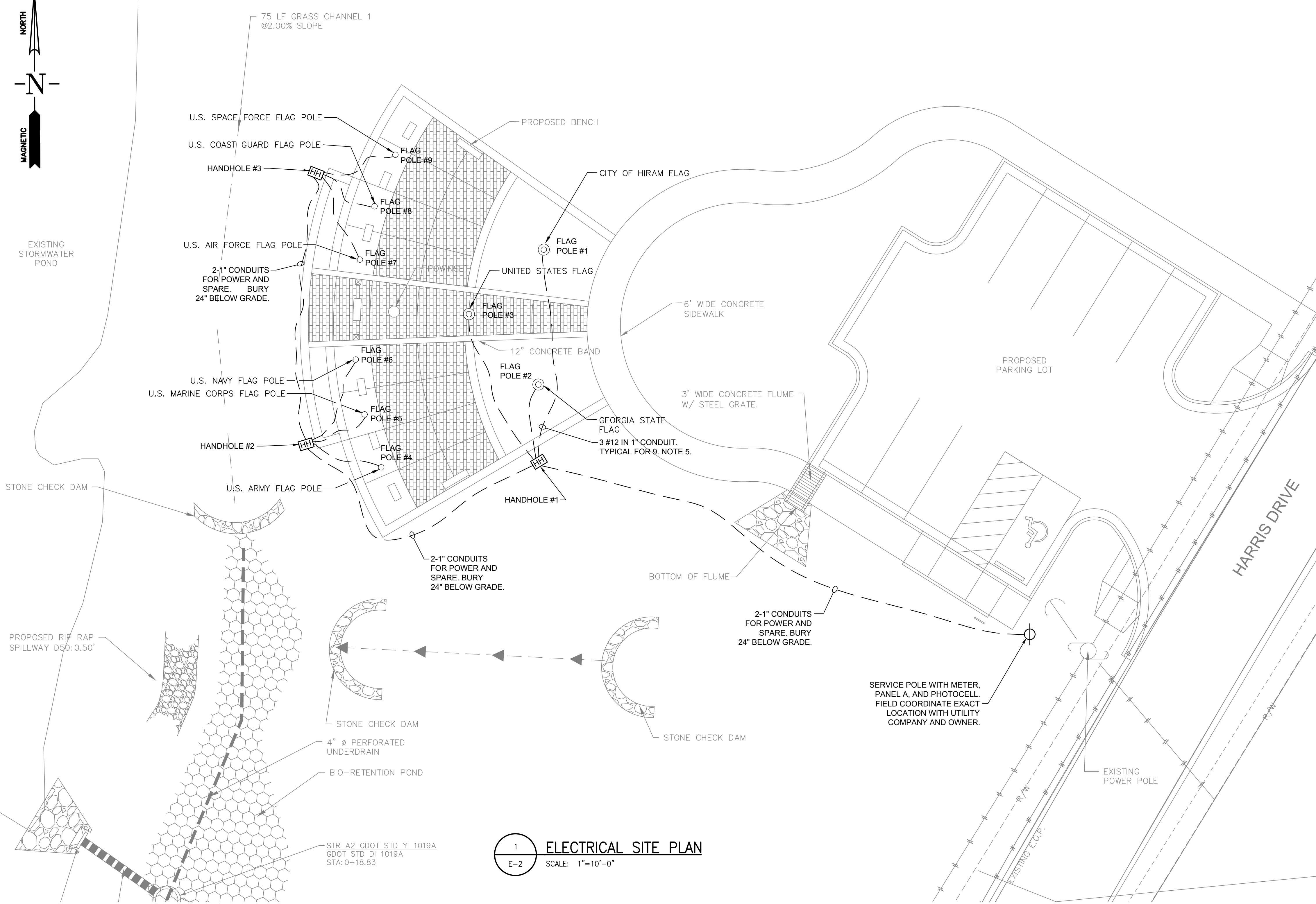
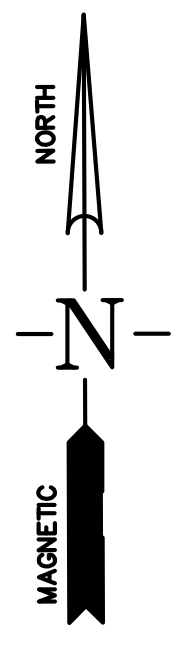

1 ELECTRICAL SITE PLAN
E-2 SCALE: 1"=10'-0"

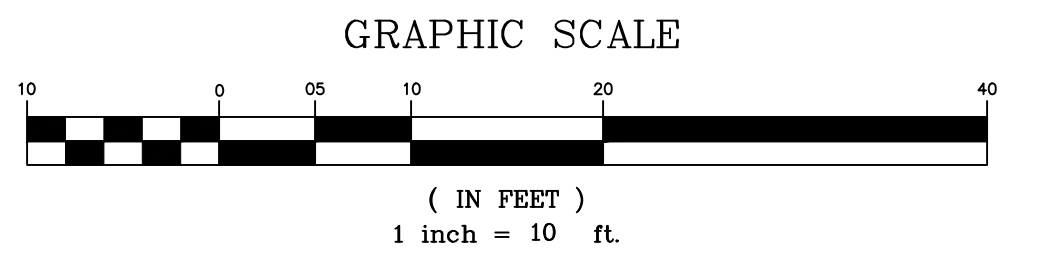

- ELECTRICAL NOTES:**
1. THE ELECTRICAL INSTALLATION SHALL COMPLY WITH THE LATEST EDITIONS OF BOTH THE NATIONAL ELECTRICAL CODE AND THE NATIONAL ELECTRICAL SAFETY CODE, AS WELL AS ALL STATE AND LOCAL CODES.
 2. CONTRACTOR SHALL COORDINATE CONDUITS ROUTING WITH ALL UNDERGROUND UTILITIES. IN CASE OF CONFLICT CONTRACTOR SHALL RE-ROUTE CONDUITS AT NO EXTRA COST TO THE OWNER.
 3. ALL UNDERGROUND CONDUITS SHALL HAVE RIGID ELBOWS.
 4. HANDHOLE SHALL BE A 11"x18" / 18" DEEP QUAZITE TYPE BOX WITH BOLTS. PROVIDE QUAZITE CAT #PG1118BA18 BOX W/ PGP1118HH17 COVER. INSTALL ON 12" BED OF #57 CRUSHED STONE. TYPICAL FOR 3 HANDHOLES.
 5. ROUTE 3 #12 IN 1" CONDUIT FROM HANDHOLE TO CENTER OF FLAG POLE. FLAG POLE WILL BE PROVIDED WITH INTEGRAL LIGHTING SYSTEM. INSTALL IN ACCORDANCE WITH MANUFACTURER'S INSTRUCTIONS.

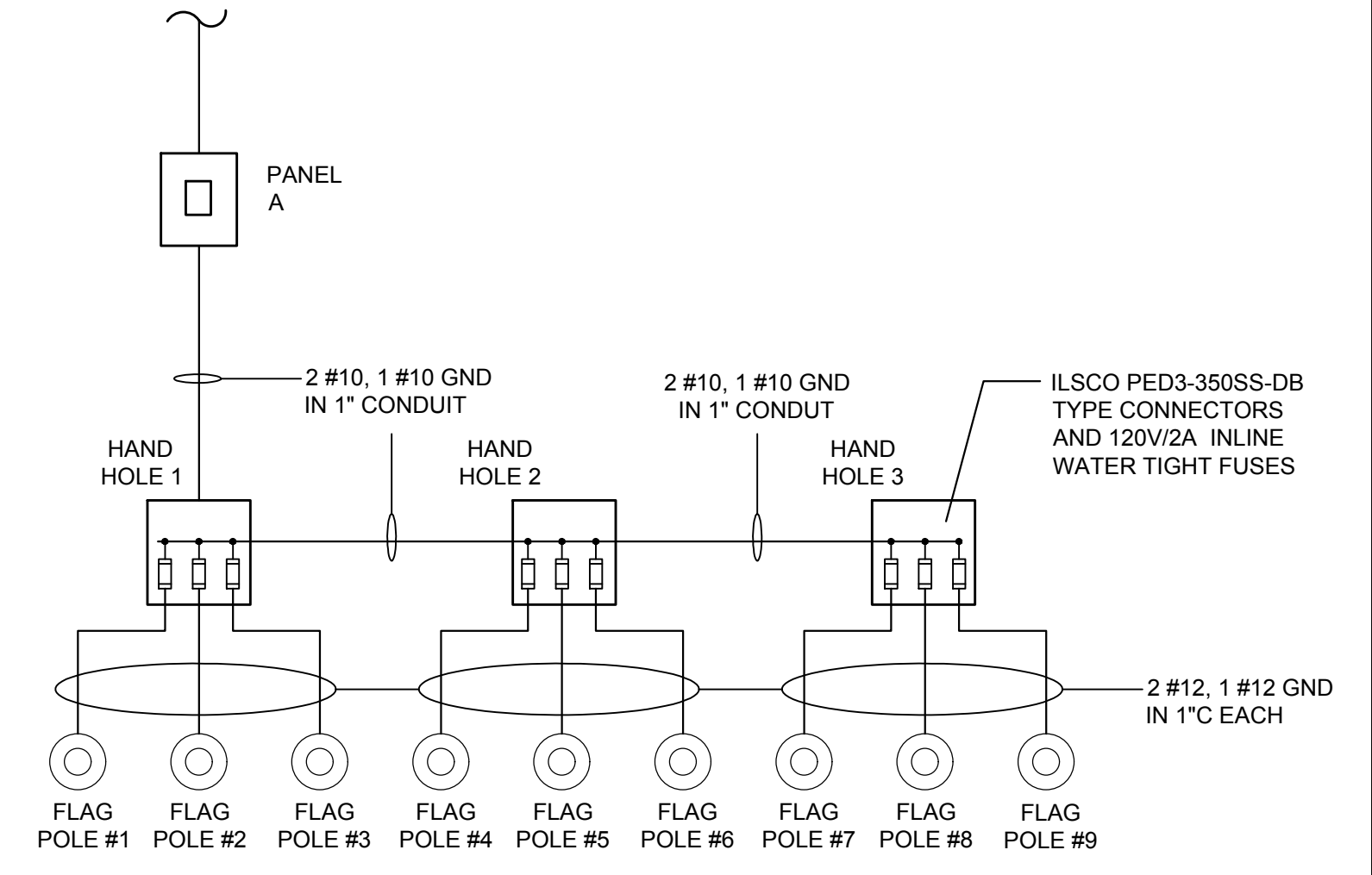

2 SCHEMATIC DIAGRAM
E-2 SCALE: N.T.S.

PREPARED BY:
HRC
HUGHES-RAY COMPANY, INC.
ENGINEERING SURVEYING LANDSCAPE ARCHITECTURE
6554 EAST CHURCH STREET
DOUGLASVILLE, GEORGIA 30134
P 770.942.0196
F 770.942.0152
www.HughesRay.com

REVISION	
No. DATE	

ELECTRICAL SITE PLAN
OF
HIRAM VETERAN'S MEMORIAL
L.L. 753, 2nd DISTRICT, 3rd SECTION
CITY OF HIRAM, PAULDING COUNTY, GEORGIA

OWNER:
CITY OF HIRAM

DEVELOPER:
JODY PALMER

24 HR. CONTACT:
CONTACT NAME
678.776.8929



DATE: 02/21/24
DRAWN BY: AP
CHECKED BY: DMZ
JOB#: H23221
E-2

ESAD PROJECT #24007

ESAD, LLC
885 WOODSTOCK ROAD
SUITE 430-231
ROSWELL, GA 30075
PH: 678-469-5196